



## Assembly Guide

Check out our other products online at [www.copernicused.com](http://www.copernicused.com)

For assistance, please contact us by telephone at **1-800-267-8494** or email at [info@copernicused.com](mailto:info@copernicused.com).

Have your packing slip ready for reference.

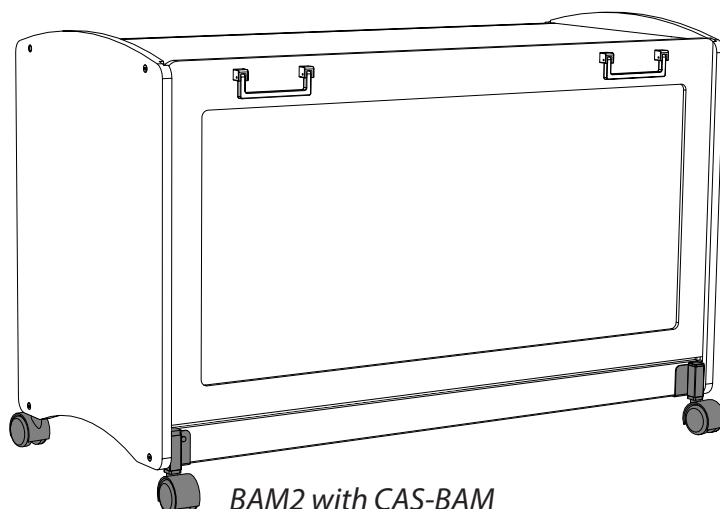

# Customer Service & Warranty Information

Dear Educator,

Thank you for purchasing the Caster Kit for BAM1 and BAM2. We hope it meets your expectations and you and your students enjoy using it at your school.

Every day we see and hear stories of teachers going above and beyond to help students thrive. Thank you so much for all you do – you are awesome, and you make a difference.

Thank you for inspiring us.

If you have any questions, concerns or ideas on how we can improve please let us know by contacting our Customer Service team at 1-800-267-8494 or **info@copernicused.com**.

Happy teaching,

Kaylyn Belcourt, President  
kaylyn@copernicused.com



We do not inherit the earth  
from our ancestors, we  
borrow it from our children.

- NATIVE AMERICAN PROVERB

Change is the end result of all  
true learning.

- LEO BUSCAGLIA

What you leave behind is not  
what is engraved in stone  
monuments, but what is  
woven into the lives of others.

- PERICLES

Education is the most  
powerful weapon which you  
can use to change the world.

- NELSON MANDELA

## For missing parts and other issues regarding your product:

Please contact Customer Service, where we will be happy to help.

Telephone: 1-800-267-8494, Monday - Friday 8:00am - 4:30 pm EST

Email: info@copernicused.com

**Need Support?  
Have a Question?**



Email **Customer Service**

**Check out some of our  
other great products!**



www.copernicused.com

**Lifetime**  
All Components  
Warranty

## Register your Product

Registering your warranty ensures we have all the information we need to make any future warranty claims quick and easy. Please visit **www.copernicused.com/warranty** and complete the form within 10 business days from product assembly. By registering your product, you will be entered into a draw to win Copernicus product.

## Make a Warranty Claim

We offer a Lifetime Warranty on almost everything we make. Please call **1-800-267-8494** or email **info@copernicused.com** to start your warranty claim. Proof of purchase will be required upon warranty claim (i.e. copy of invoice).

# Tips for Assembly

## Before You Begin:

- Lay out and identify all of the included parts.
- The hardware has been packed according to step
- Read the assembly guide over once to familiarize yourself with them.

## As You Assemble the Unit:

- Follow the steps in sequence.
- Before beginning each step, find the part(s) that you need for that step.
- The title of each step states what you will be doing. Review the text and the pictures as you build the unit.

## Watch for These Helpful Symbols:



2-Person Task

For safety, please have someone help you when working on steps displaying this symbol.



The symbol denotes a step needing extra attention to ensure it is done correctly.



# Important Information! Warning!

Please read the warnings below for important safety information regarding your product. Failure to read these warnings or to follow the instructions below could result in personal injury or damage to your product that could void your warranty.



### Small Parts

In its unassembled state, this product contains parts that can be hazardous to small children. This product should be assembled by an adult.



### Adult Supervision

This product is to be used under the supervision of an adult.



### Climb Hazard

Do not climb on, hang from or suspend objects from any components of your product unless otherwise specified.



### Indoor Use Only

This product is intended for indoor commercial use only. To reduce the risk of fire or electric shock, do not expose this product to rain or moisture. The internal components are not sealed from the environment.



### Do Not Use Power Tools

This product is not intended to be assembled with the use of power tools. Please use specified hand tools only, failure to do so may result in damage to the product.

# Parts

## Before beginning, you should have:

Additional tools required:

Adjustable wrench 1x OR 8mm

Rubber Mallet 1x

### Box 1

Locking Caster  
4x

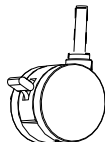

Caster Bracket  
(Left)  
2x

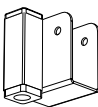

Caster Bracket  
(Right)  
2x

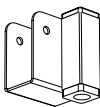

In Box 1

### Hardware Actual Size

A M5 x 35mm  
4x



B M5 Flat Washer  
4x



C M5 Spring Washer  
4x



D M5 Nut  
4x



### Tools (Not to Scale)

Allen Key  
(43281)  
2x

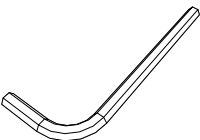

# 1

You will need: (Not to Scale)

Locking Caster

4x



Caster Bracket

(Left)

2x

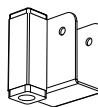

Caster Bracket

(Right)

2x

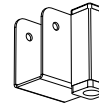

Rubber Mallet 1x



## Insert caster into Caster Bracket

Caster Bracket  
(Left)

2x

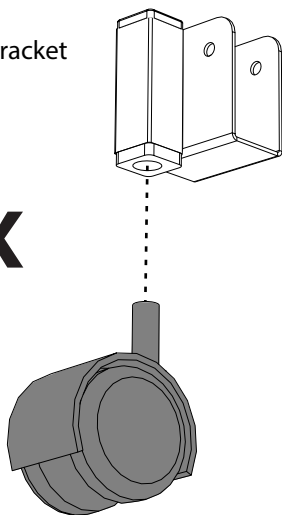

Press Casters firmly into the bracket:



Casters will click into place.  
If necessary, tap the caster in  
using a rubber mallet.

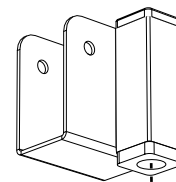

Caster Bracket  
(Right)

2x

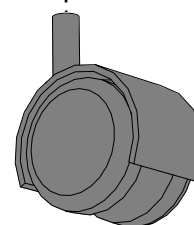

2  
2-Person Task

You will need: (Not to Scale)

Caster Bracket  
Assembly  
(Left)

1x

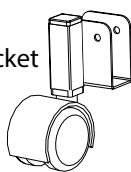

Caster Bracket  
Assembly  
(Right)

1x



## Place BAM on its FRONT, slide Caster Bracket over bottom back kick plate

①

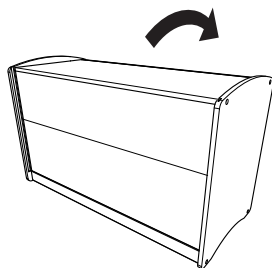

②

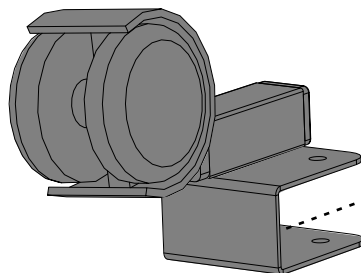

Caster Bracket  
Assembly  
(Left)

Align hole on bracket with  
the hole in the kickplate

Caster Bracket  
assembly should fit  
tight up against the  
side panel of the  
assembled BAM

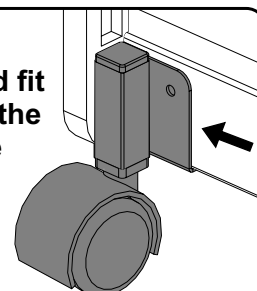

# 3

Actual Size:

(A)  
2x



(B)  
2x



(C)  
2x



(D)  
2x



## Install hardware to secure first two caster brackets

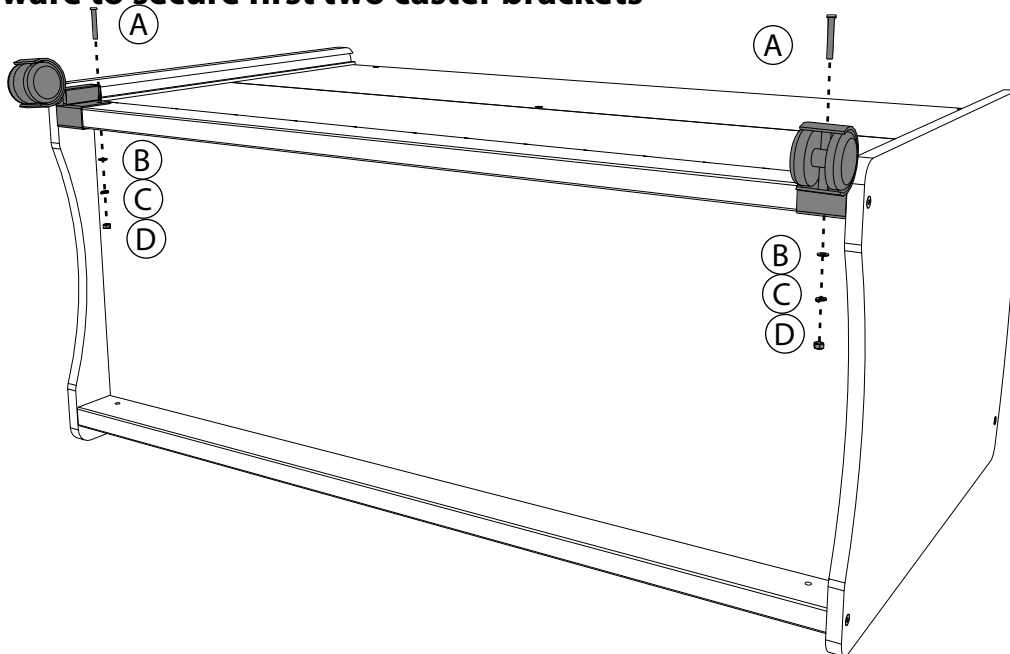

# 4

Actual Size:

(A)  
2x



(B)  
2x



(C)  
2x



(D)  
2x



You will need: (Not to Scale)

Caster Bracket  
Assembly  
(Left)  
1x

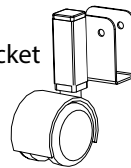

Caster Bracket  
Assembly  
(Right)  
1x

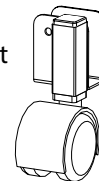

2-Person Task

## Flip unit over and install Caster Brackets on the front

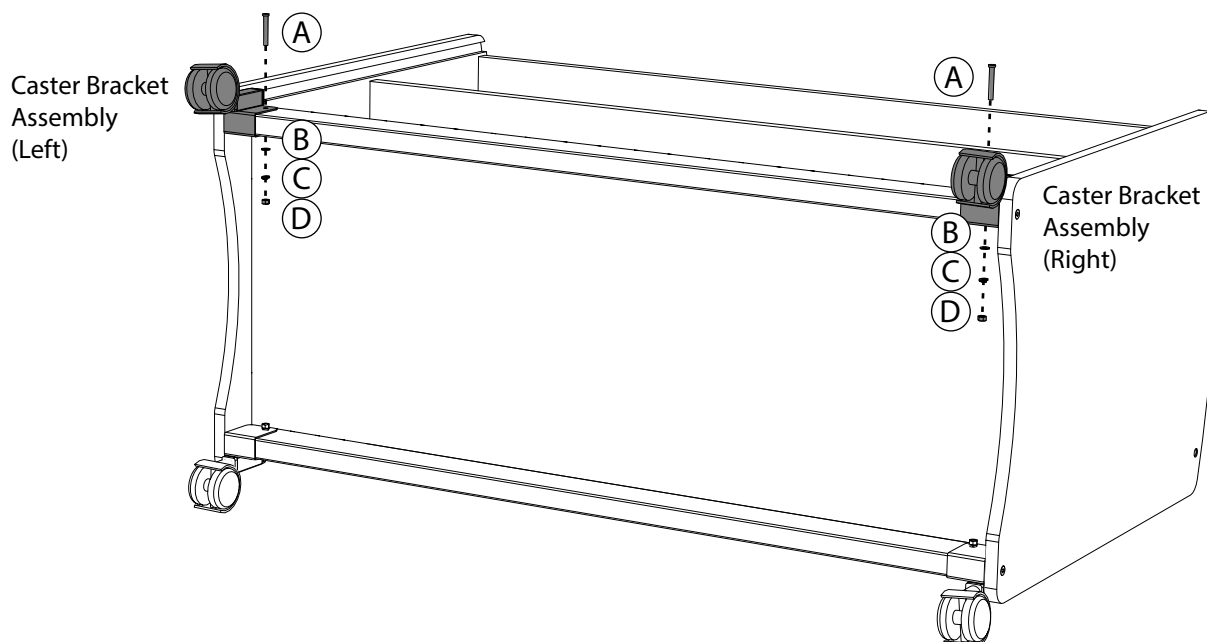



2-Person Task

You will need: (Not to Scale)

**Flip BAM up onto the casters. Check entire assembly for loose parts and fasteners. Enjoy!**

