

# Clear Dry-Erase Single Room Divider



## Assembly Guide CS7-CLR 2020 A

Check out our other products online at  
[www.copernicused.com](http://www.copernicused.com)

For assistance, please contact us:

**1-800-267-8494**

Email [info@copernicused.com](mailto:info@copernicused.com)

Have your packing slip ready for reference

## WARNING !

- This product is meant to be assembled by an adult.
- In its unassembled state, small parts present a hazard.
- To be used under direct supervision of an adult.

**Need Tech Support?  
Have a Question?**



[email our tech support service](mailto:our_tech_support_service)

**Check out some of our  
other great products!**



[www.copernicused.com](http://www.copernicused.com)

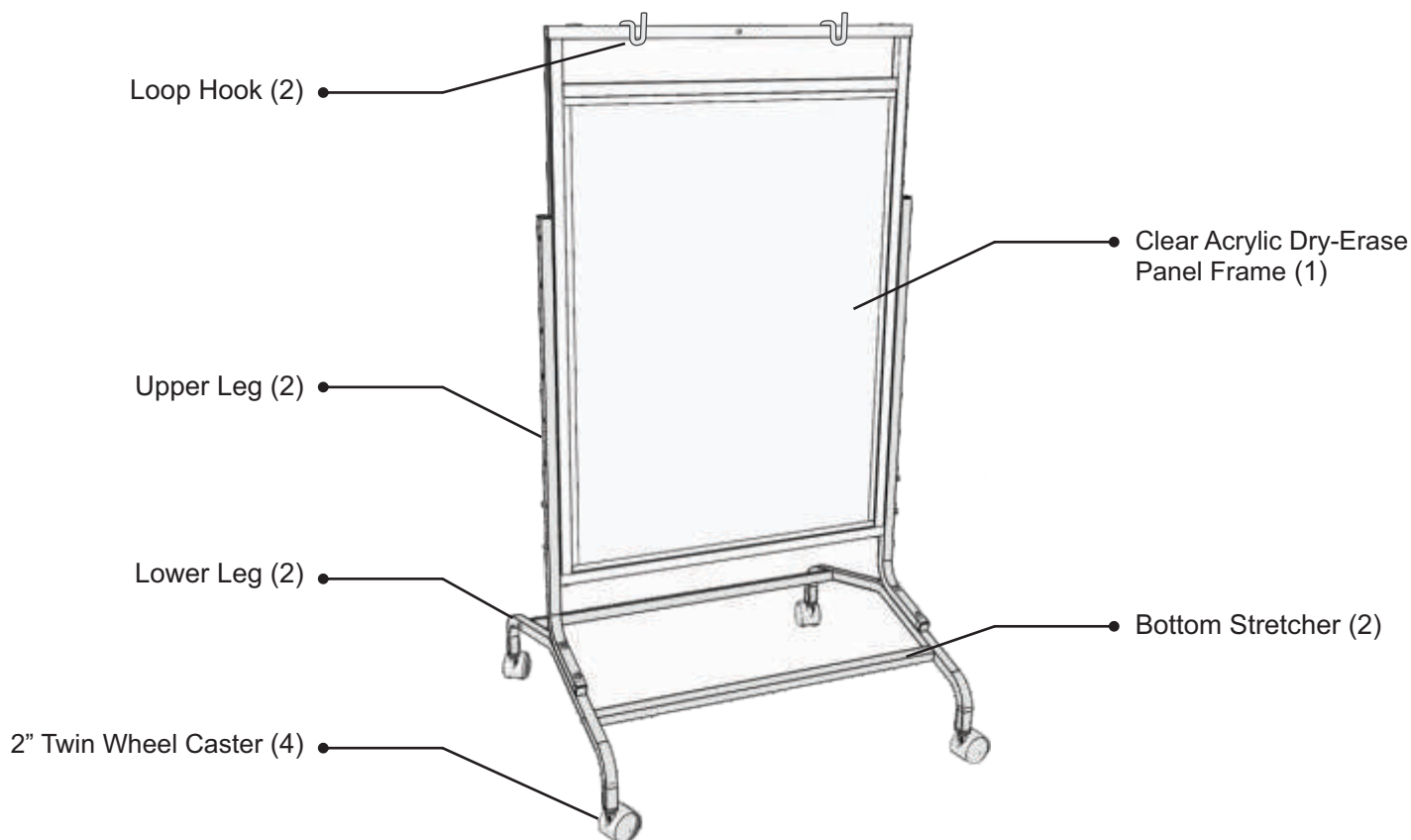

# Clear Dry-Erase Single Room Divider



## Assembly Guide CS7-CLR 2020 A

Check out our other products online at  
[www.copernicused.com](http://www.copernicused.com)

For assistance, please contact us:

**1-800-267-8494**

Email [info@copernicused.com](mailto:info@copernicused.com)

**Have your packing slip ready for reference**

Dear Educator,

Thank you for purchasing one of our products.

I hope the assembly of your Clear Dry-Erase Single Room Divider went well.

If you have any questions, or concerns, or ideas for how we can improve, please call us at 1-800-267-8494, where someone will be happy to help.

Enjoy using your new product, and happy teaching,

*Kaylyn Belcourt*  
President

Quality schools are the  
result of quality teachers  
going above and beyond  
the call of duty.

VICKI CARUANA

In everyone's life at some  
time our inner fire goes  
out. It is then burst into  
flame by an encounter  
with another human  
being. We should all be  
thankful for those people  
who rekindle the inner  
spirit.

ALBERT SCHWEITZER

My idea of education is  
to unsettle the minds of  
the young and inflame  
their intellects.

ROBERT MAYNARD  
HUTCHINS

Nothing has a better  
effect upon children than  
praise.

SIR PHILLIP SIDNEY



## Before beginning, you should have:

Additional tools required:

Adjustable wrench

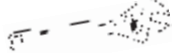

Rubber Mallet



### Contents - Box 1

Clear Acrylic Dry-Erase Panel Frame  
**1x**



Bottom Stretcher  
**2x**



Lower Leg  
**2x**



Loop Hook  
**2x**



Upper Leg  
**2x**



2" Twin Wheel Caster  
**4x**



### In Box 1

Hardware  
*Actual Size*

(A) M6 x 45mm  
**4x**



(B) M6 x 35mm  
**8x**



(C) M6 Hex Nut  
**4x**



(D) Lock Washer  
**12x**



Allen Key  
(Not to Scale)  
**1x**



# Tips for Assembly - Using this Manual



2 Person

## Watch for These Helpful Symbols

- This symbol denotes a 2 Person Task. For safety, please ensure that there are two people working on steps displaying this symbol



- Watch for this symbol throughout the Assembly Instructions. Wherever you see it, pay close attention. The symbol denotes a step needing extra attention to ensure it is done correctly.



- The Star symbol highlights an advisory note

## Before You Begin



- Layout and identify all of the included parts
- The hardware has been packed by step
- Read the assembly instructions over once to familiarize yourself with them
- Please note that in its unassembled state, this product contains parts that can be a hazard to small children; it should be assembled by an adult.

## As You Assemble the Unit



- Follow the steps in sequence
- Before beginning each step, find the part(s) that you need for that step
- Pay attention to the labeling on the parts, they are there to help direct you at certain stages
- The title of each step states what you will be doing. Review the text and the pictures as you build the unit.

## After Assembly; Before Use

- Remove the plastic film from the acrylic panel before writing on it

Don't forget to check out our tips for your acrylic panel at:  
[www.copernicused.com/help/tips](http://www.copernicused.com/help/tips)

**Life  
Time**

Frame & Tub  
Warranty

**2  
Year**

Acrylic  
Warranty

## Validate Your Warranty On-Line

To validate your warranty submit the ON-LINE form at [www.copernicused.com](http://www.copernicused.com)

“The beautiful thing about learning is that no one can take it away from you.” - B. B. King



1

Actual Size:

You will need: (Not to Scale)



2" Twin Wheel Caster  
x 4



Lower Leg  
2x

## Install 2" Casters



Press Casters firmly into the Base:

- Casters will click into place
- If necessary, tap the caster in using a rubber mallet.

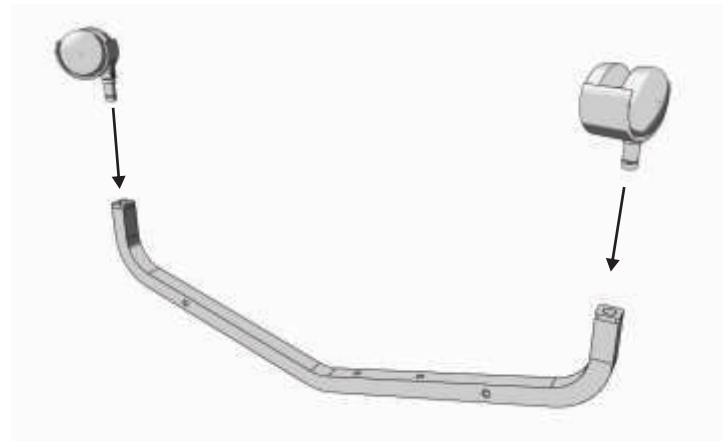

Build x 2

2

Actual Size:



(A)  
M6 x 45mm  
x 4



(C)  
M6 Hex Nut  
x 4



(D)  
Lock Washer  
x 4

You will need: (Not to Scale)



Upper Leg  
2x

## Bolt Lower Legs To Upper Legs

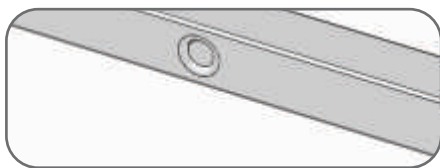

! Hole indents on Upper Leg  
should face same side as Lower Leg.

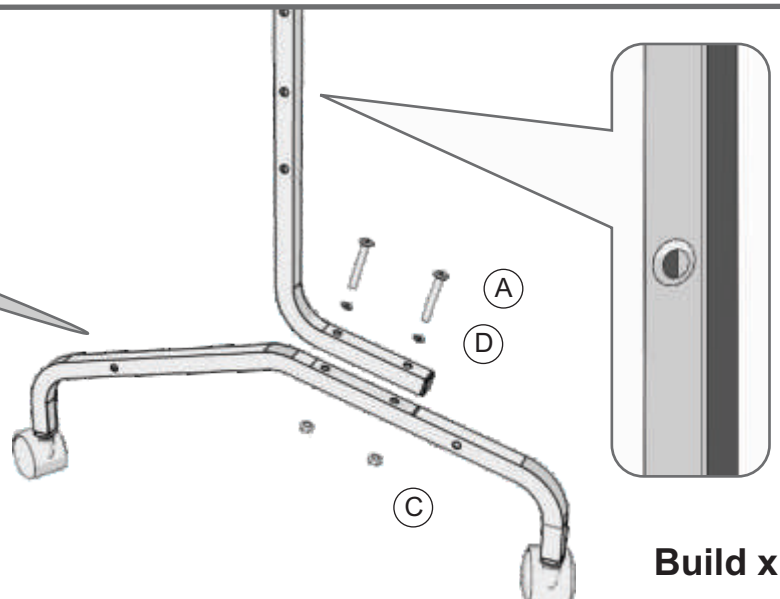

Build x 2



3

Actual Size:



(B)

M6 x 35mm  
x 4



(D)

Lock Washer  
x 4

You will need: (Not to Scale)



Bottom Stretcher  
2x

## Install Stretchers

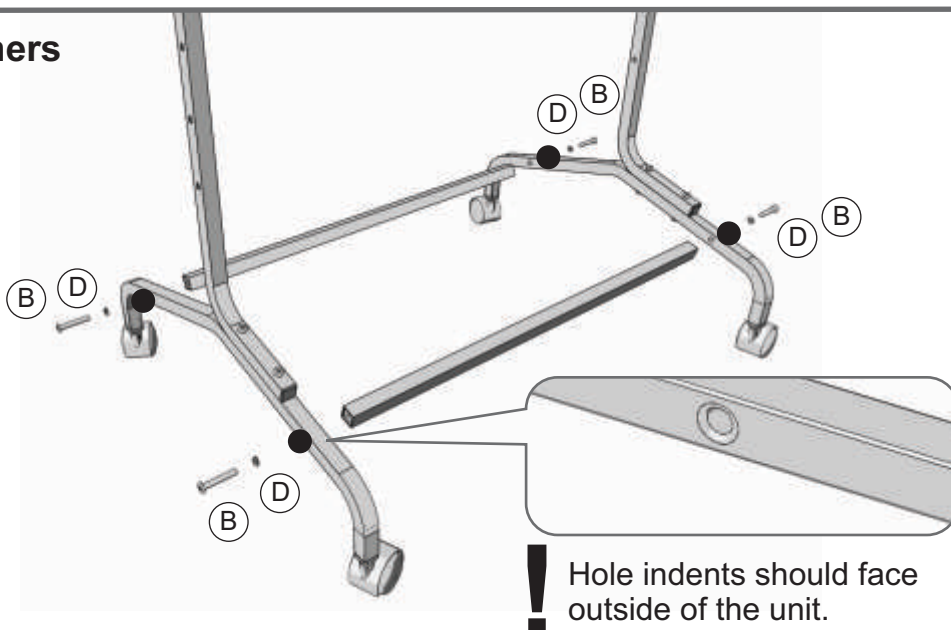

4

Actual Size:



(B)

M6 x 35mm  
x 4



(D)

Lock Washer  
x 4

You will need: (Not to Scale)

## Install Clear Acrylic Dry-Erase Panel Frame Onto Base



### Select your panel height

- Junior/intermediate - higher position
- Early childhood/primary - lower position

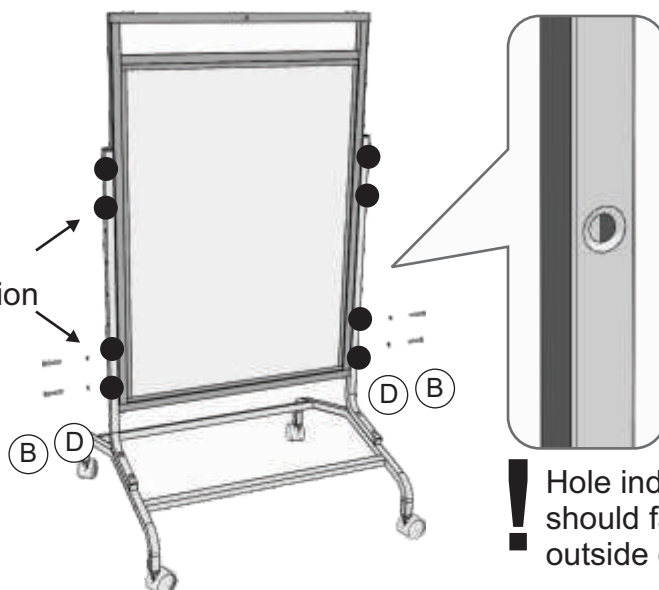

5

Actual Size:

You will need: (Not to Scale)



Loop Hook  
2x

## Install Loop Hooks & Chart Hooks



To avoid scratching the paint place an empty plastic bag over the frame, install hooks, then remove

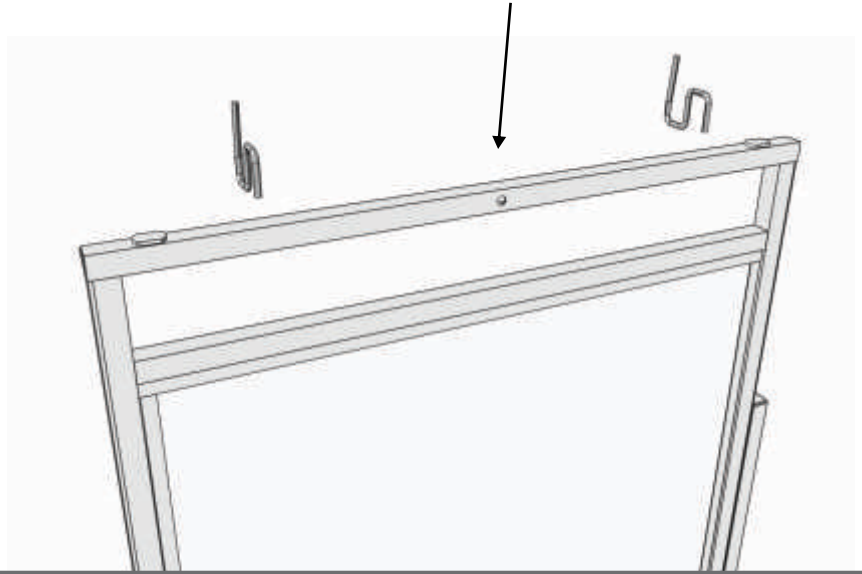

6

Actual Size:

You will need: (Not to Scale)

## Remove Protective Film from Panel

