

CS700-EXT

# Outdoor Deluxe Chart Stand



## Assembly Guide

CS700-EXT\_2021\_A

Check out our other products online at  
[www.copernicused.com](http://www.copernicused.com)

For assistance, please contact us:

**1-800-267-8494**

Email [info@copernicused.com](mailto:info@copernicused.com)

**Have your packing slip ready for reference**

## WARNING



- This product is meant to be assembled by an adult.
- In its unassembled state, small parts present a hazard.
- To be used under direct supervision of an adult.

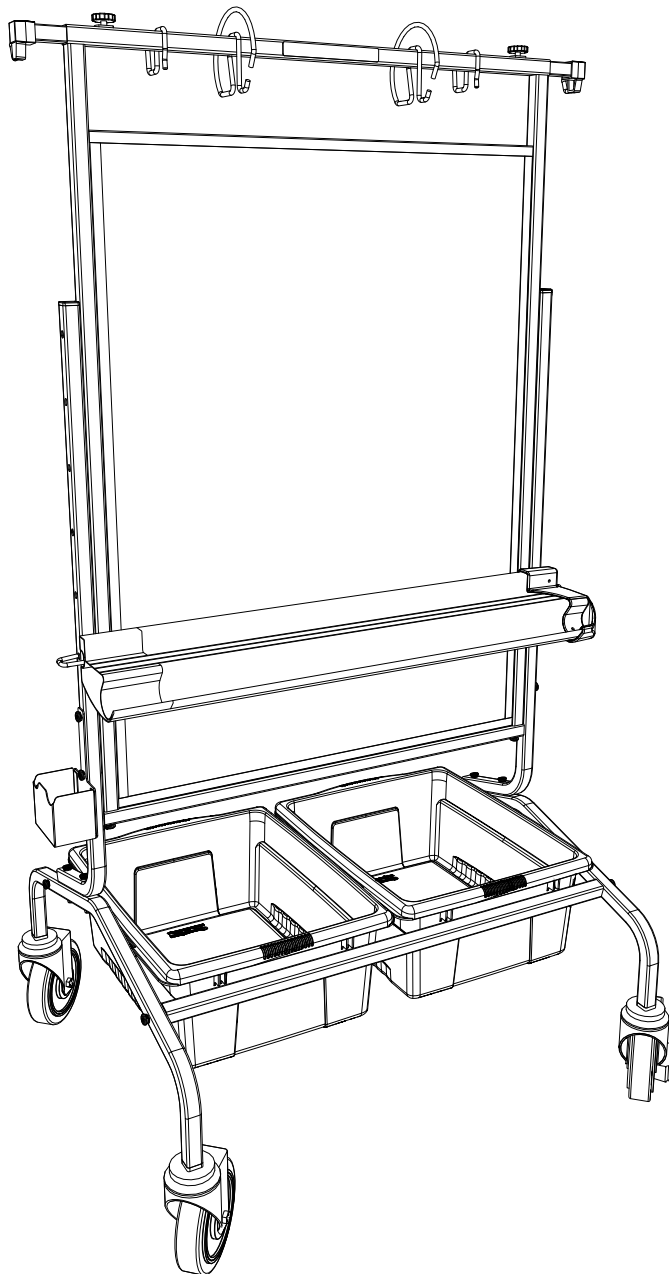

**Assembly Guide**

CS700-EXT\_2020\_A

Check out our other products online at

[www.copernicused.com](http://www.copernicused.com)

For assistance, please contact us:

**1-800-267-8494**Email [info@copernicused.com](mailto:info@copernicused.com)**Have your packing slip ready for reference**

Dear Educator,

Thank you for purchasing the Outdoor Deluxe Chart Stand. We hope it meets all your expectations and you and your students enjoy using it in your school.

If you have any questions, concerns or ideas on how we can improve please let us know by contacting our Customer Solutions Ninjas at 1-800-267-8494 or [info@copernicused.com](mailto:info@copernicused.com).

Happy teaching,

Kaylyn Belcourt  
President

We do not inherit the earth from our ancestors, we borrow it from our children.

Change is the end result of all true learning.

What you leave behind is not what is engraved in stone monuments, but what is woven into the lives of others.

Education is the most powerful weapon which you can use to change the world.

LEO BUSCAGLIA

NORTH AMERICAN

PROVERB

PERICLES

NELSON MANDELA

**Lifetime**Frame & Tub  
Warranty**Register your Product**

Registering your warranty ensures we have all the information we need to make any future warranty claims quick and easy. Please visit [www.copernicused.com/warranty](http://www.copernicused.com/warranty) and complete the form within 10 business days from product assembly. By registering your product, you will be entered into a draw to win Copernicus product.

**5****Year**Whiteboard  
Warranty**Make a Warranty Claim**

We offer a Lifetime Warranty on almost everything we make. Please call 1-800-267-8494 or email [info@copernicused.com](mailto:info@copernicused.com) to start your warranty claim. Proof of purchase will be required upon warranty claim (i.e. copy of invoice).

**Replace your Whiteboard**

Have a well-used whiteboard that needs replacing? Our whiteboards carry a five-year warranty and replacement parts program after the warranty period. Please call 1-800-267-8494 or email [info@copernicused.com](mailto:info@copernicused.com) to get a new whiteboard for your Copernicus product!



**Before beginning, you should have:**

Additional tools required:



Adjustable wrench 2x

+

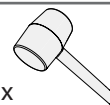

Rubber Mallet 1x

## CS700-EXT-0

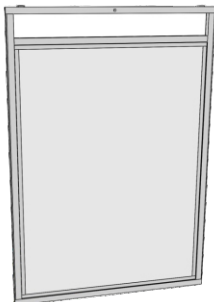
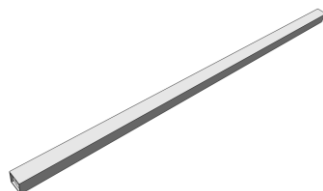
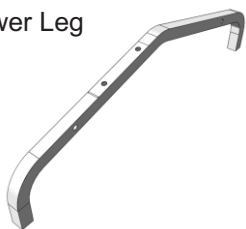
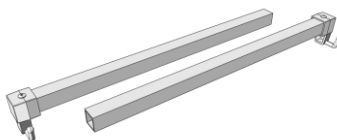
Whiteboard Frame with Whiteboard  
1xBottom Stretcher  
2xLower Leg  
2xTelescoping Arms  
2xUpper Leg  
2xChart Hook  
2xLoop Hook  
2x

In Box 1

Hardware  
Actual SizeⒶ M6 x 45mm  
4xⒷ M6 x 35mm  
8xⒸ M6 Hex Nut  
4xⒹ Lock Washer  
12xKnob  
(Not to Scale)  
2xAllen Key  
(Not to Scale)  
1x

## CS700-CB

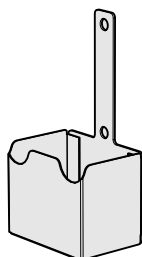
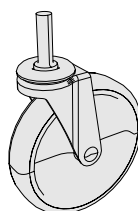
Hand Sanitiser  
Bottle Holder  
1xCasters  
4x  
2x locking, 2x non-lockingOpen Tub  
2x  
(CC4068)

10 lbs Weight Limit

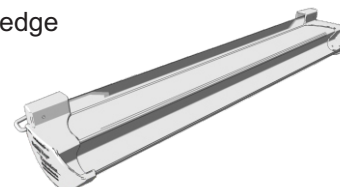
Book Ledge  
1x

# Tips for Assembly

## Watch for These Helpful Symbols

This symbol denotes a 2-Person Task. For safety, please ensure that there are the suggested number of people working on steps displaying this symbol.



Watch for this symbol throughout the Assembly Guide. Wherever you see it, pay close attention. The symbol denotes a step needing extra attention to ensure it is done correctly.



The star symbol highlights an advisory note.



## Before You Begin

- Lay out and identify all of the included parts.
- The hardware has been packed according to step.
- Read the assembly guide over once to familiarize yourself with them.



 Please note that in its unassembled state, this product contains parts that can be hazardous to small children. This product should be assembled by an adult.

 Please note, star washers are critical components for electrical safety. Star washers must be included and fasteners fully tightened to prevent the risk of electric shock..



## As You Assemble the Unit

- Follow the steps in sequence.
- Before beginning each step, find the part(s) that you need for that step.
- Pay attention to the labels on the parts; they are there to help direct you at certain stages.
- The title of each step states what you will be doing. Review the text and the pictures as you build the unit.

# Customer Service - FAQ's



### For missing parts and other issues:

Please call Copernicus Customer Service, where we will be happy to help.

1-800-267-8494. Monday - Friday 8:00am - 4:30 pm EST.

OR

Email Customer Service at [info@copernicused.com](mailto:info@copernicused.com)

**Check out some of our  
other great products!**



[www.copernicused.com](http://www.copernicused.com)



1

Actual Size:

You will need: (Not to Scale)

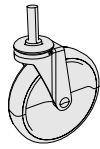

Caster  
x 4

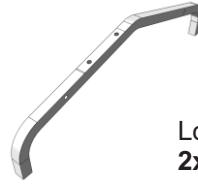

Lower Leg  
2x

## Install Casters

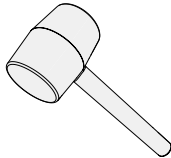

Press Casters firmly into the Base:

- Casters will click into place
- If necessary, tap the caster in using a rubber mallet.

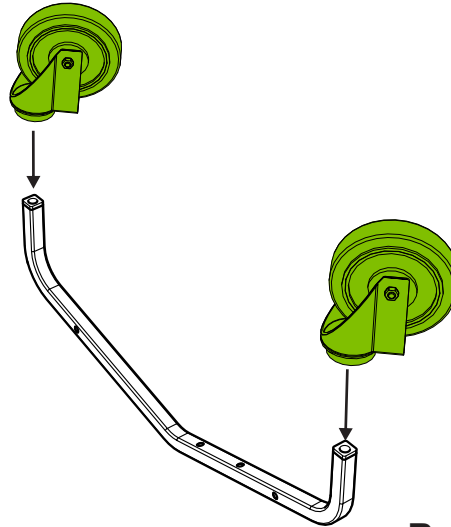

Build x 2

2

Actual Size:



(B)  
M6 x 35mm  
x 4



(D)  
Lock Washer  
x 4

You will need: (Not to Scale)

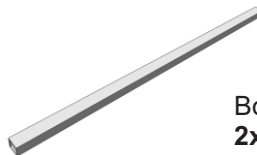

Bottom Stretcher  
2x

## Install Stretchers

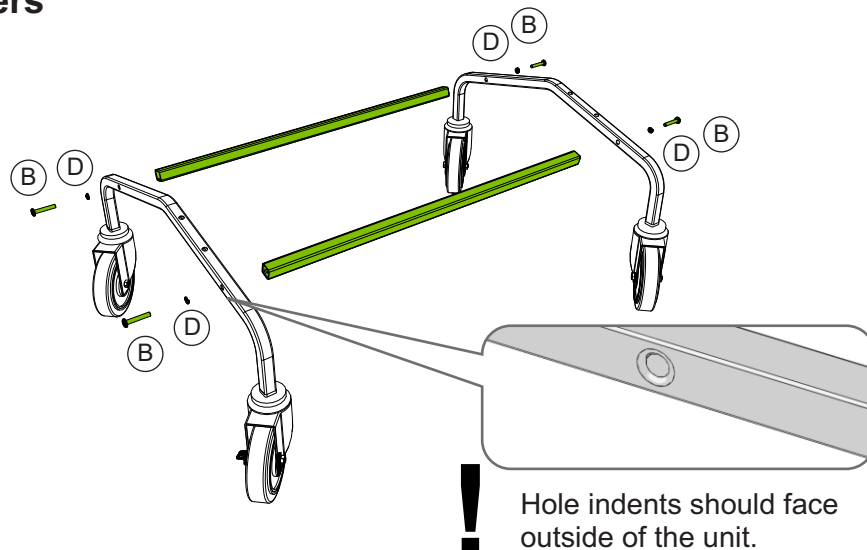

3

Actual Size:



(A)  
M6 x 45mm  
x 4



(D)  
Lock Washer  
x 4

You will need: (Not to Scale)

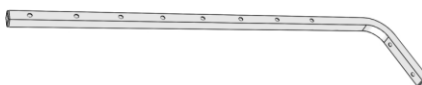

Upper Leg  
2x

## Bolt Lower Legs To Upper Legs

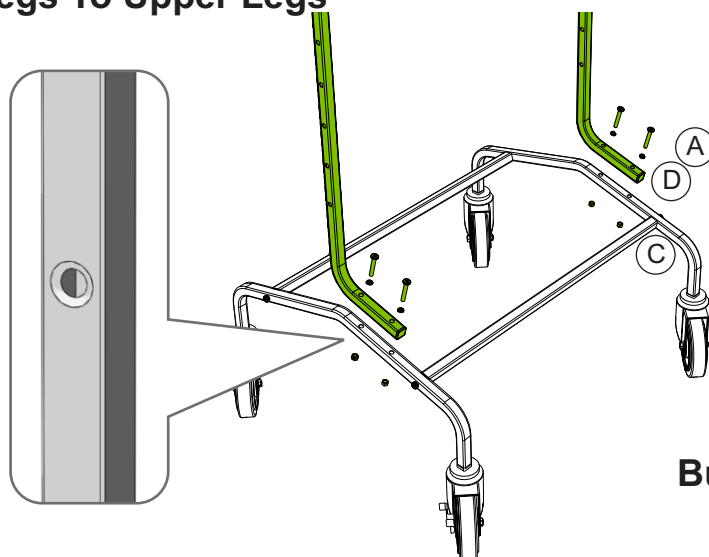

Build x 2

4

Actual Size:



(B)  
M6 x 35mm  
x 4



(D)  
Lock Washer  
x 4

You will need: (Not to Scale)

Hand Sanitiser  
Bottle Holder  
1x

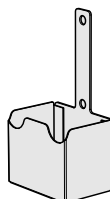

Whiteboard Frame  
with Whiteboard  
1x



## Install Bottle Holder and Whiteboard Frame onto Base



### Select your whiteboard height

- Early childhood/primary - lower position
- Junior/intermediate - higher position

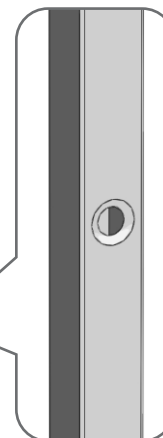
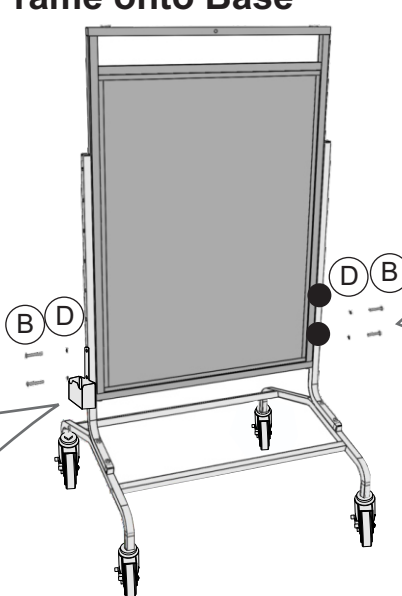
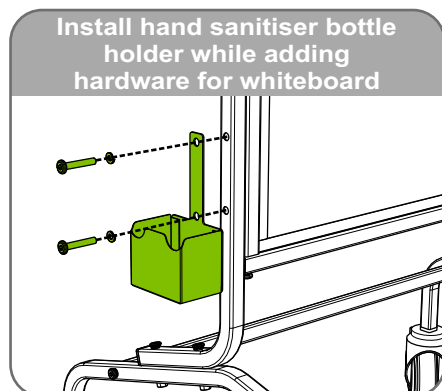

! Hole indents  
should face  
outside of the unit.

5

Actual Size:

You will need: (Not to Scale)



Knob  
2x

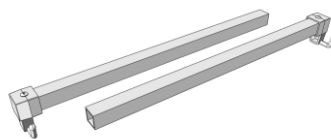

Telescoping Arms  
2x

## Install Telescoping Extensions

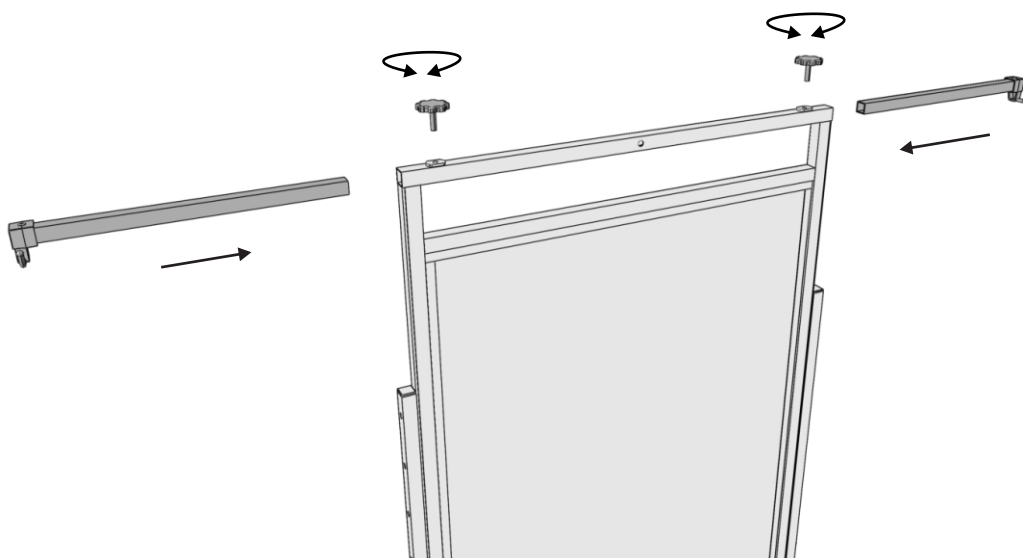

6

Actual Size:

You will need: (Not to Scale)



Book Ledge  
1x

## Install Premium Book Ledge

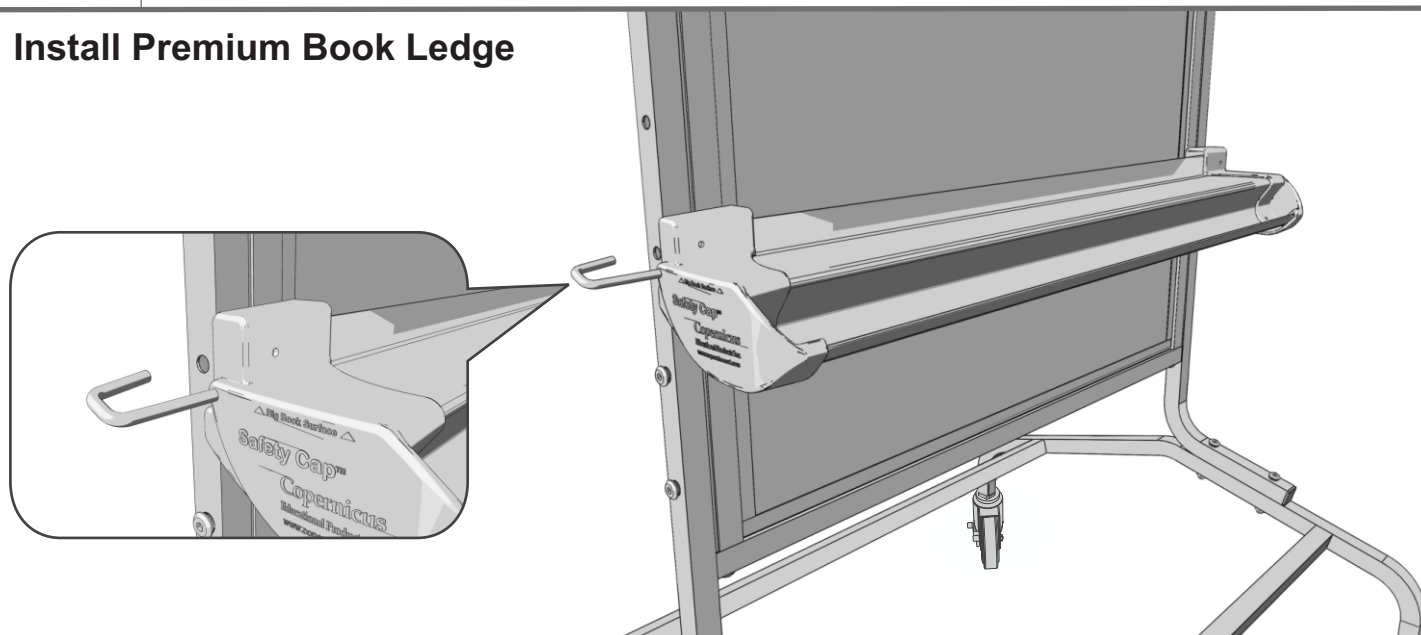

You will need: (Not to Scale)



Open Tub  
2x



Loop Hook  
2x



Chart Hook  
2x

## Install Loop Hooks, Chart Hooks & Tubs

! To avoid scratching the paint place an empty plastic bag over the frame, install hooks, then remove

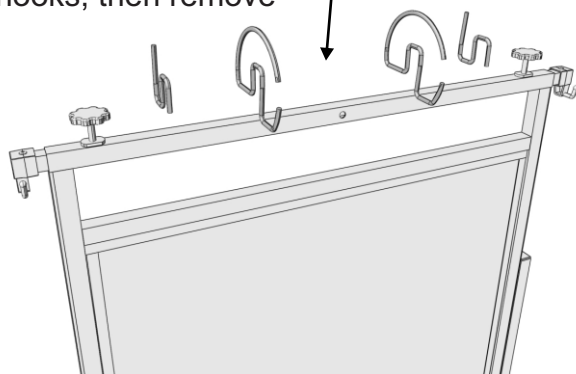

! Don't forget to peel off protective film from Whiteboard

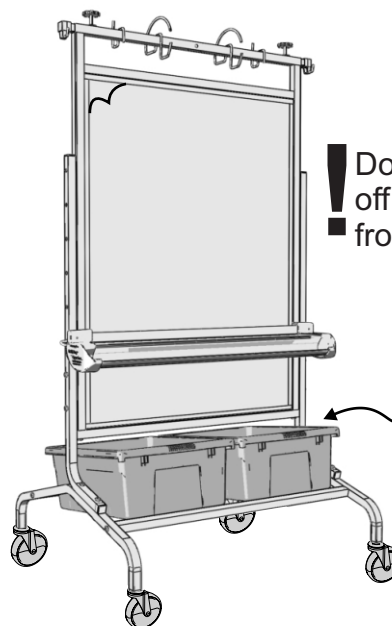

## User Tip

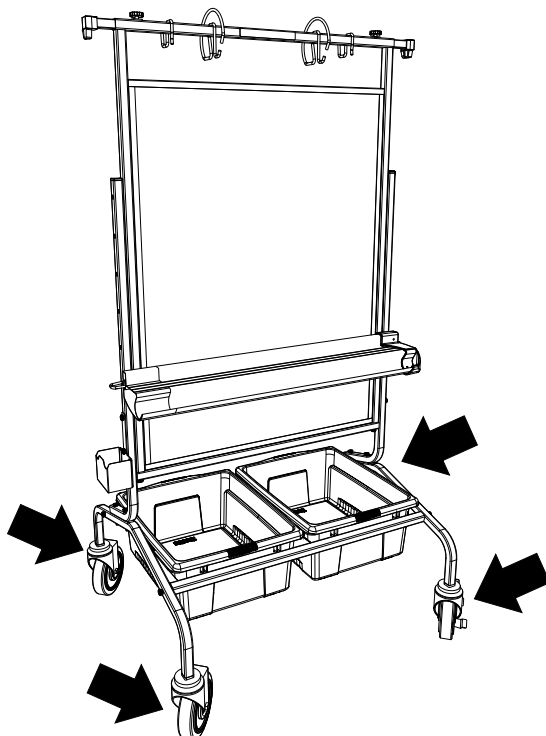

! When using this product in windy conditions, casters should be left unlocked, so that the unit rolls rather than tipping over.

