

SAN002

# Tabletop Hand Sanitizer Stand



## Assembly Guide

SAN002\_2020\_C

Check out our other products online at  
[www.copernicused.com](http://www.copernicused.com)

For assistance, please contact us:

**1-800-267-8494**

Email [info@copernicused.com](mailto:info@copernicused.com)

**Have your packing slip ready for reference**

## WARNING



- This product is meant to be assembled by an adult.
- In its unassembled state, small parts present a hazard.
- To be used under direct supervision of an adult.

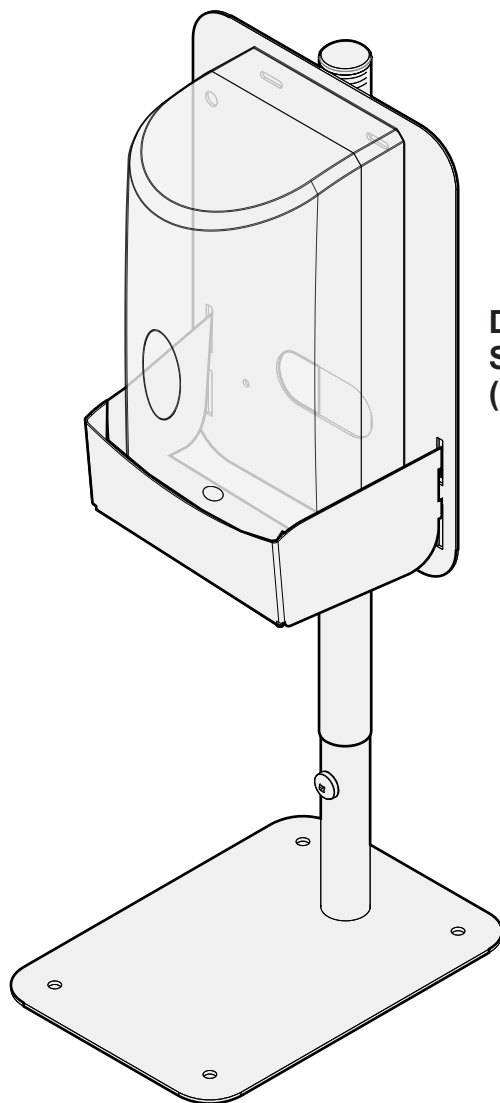

**DISPENSERS SOLD  
SEPARATELY  
(HSD1 or HSD2)**



**Please Recycle**

SAN002

# Tabletop Hand Sanitizer Stand



## Assembly Guide

SAN002\_2020\_C

Check out our other products online at  
[www.copernicused.com](http://www.copernicused.com)

For assistance, please contact us:

**1-800-267-8494**

Email [info@copernicused.com](mailto:info@copernicused.com)

**Have your packing slip ready for reference**

Dear Educator,

Thank you for purchasing the Tabletop Hand Sanitizer Stand. We hope it meets all your expectations and you and your students enjoy using it in your school. If you have any questions, concerns or ideas on how we can improve please let us know by contacting our Customer Solutions Ninjas at 1-800-267-8494 or [info@copernicused.com](mailto:info@copernicused.com).

Happy teaching,

Kaylyn Belcourt  
President

**Lifetime**  
All Components  
Warranty

### Register your Product

Registering your warranty ensures we have all the information we need to make any future warranty claims quick and easy. Please visit [www.copernicused.com/warranty](http://www.copernicused.com/warranty) and complete the form within 10 business days from product assembly. By registering your product, you will be entered into a draw to win Copernicus product.

### Make a Warranty Claim

We offer a Lifetime Warranty on almost everything we make. Please call 1-800-267-8494 or email [info@copernicused.com](mailto:info@copernicused.com) to start your warranty claim. Proof of purchase will be required upon warranty claim (i.e. copy of invoice).



## Warning! Hazard Risks!

Please read the warnings below for important safety information regarding your product. Failure to read these warnings or to follow the instructions below could result in personal injury or damage to your product that could void your warranty.



**Adult  
Supervision**

This product is to be used under the supervision of an adult.



**Small  
Parts**

In its unassembled state, this product contains parts that can be hazardous to small children. This product should be assembled by an adult.

## Customer Service - FAQ's



### For any issues:

Please call Copernicus Customer Service, where we will be happy to help.

1-800-267-8494. Monday - Friday 8:00am - 4:30 pm EST.

Email our Customer Support Service at [vanessa@copernicused.com](mailto:vanessa@copernicused.com)

**Check out some of our  
other great products!**





[www.copernicused.com](http://www.copernicused.com)

# Tabletop Hand Sanitizer Stand

## Before beginning, you should have:

Additional tools required:

Adjustable wrench  
1x  OR 5/16" (8mm) (1x)  
1/2" (13mm) (1x) + Screwdriver  
 OR 

SAN002

Back Plate  
(32282)  
1x

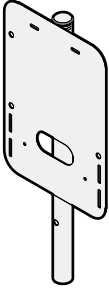

Base  
(32283)  
1x

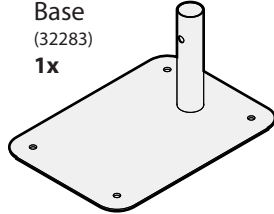

Child Lockout  
Safety Feature  
(32277)  
1x

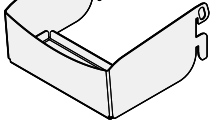

Adhesive Tape  
(700013)  
8x

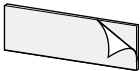

HSD1 or HSD2  
**SOLD SEPARATELY**

Dispenser  
(HSD1 or HSD2)  
1x

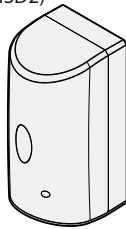

Hardware  
Actual Size

(A) 5/16-18 x 1-1/2" Philips Truss Head Screw  
(4300920)  
1x



(B) 5/16-18 Lock Nut  
(430105)  
1x



(C) 6-32 x 3/8" Pan Head Screw  
(4301352)  
4x



(D) 6-32 Hex Nut  
(430164)  
4x



(E) 11/64" Flat Washer  
(4301902)  
4x



1

You will need: (Not to Scale)

(A) 1x

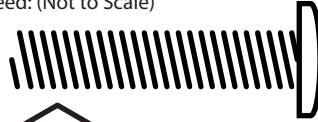

(B) 1x



## Assemble Back Plate and Base

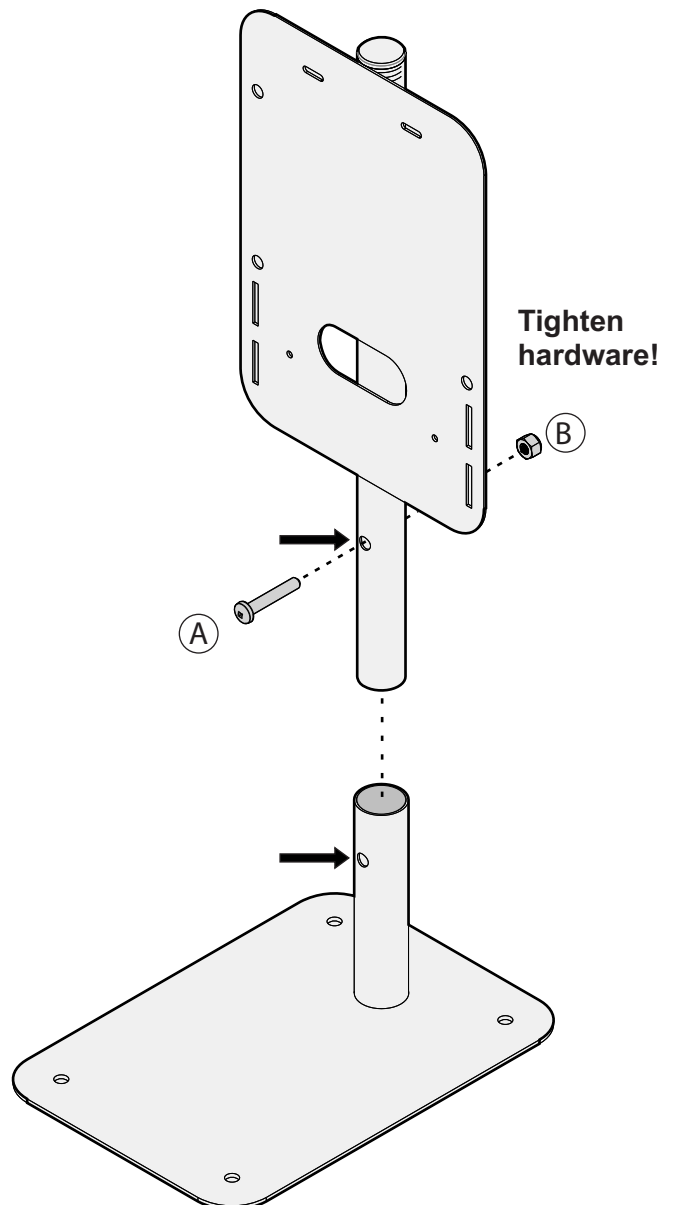

# 2A

Actual Size:



You will need: (Not to Scale)

**SOLD SEPARATELY**

Dispenser  
(HSD1 or HSD2)  
1x

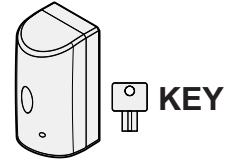

## Install Dispenser onto Back Plate

**NOTE:**

If you are using your own dispenser please proceed to next step

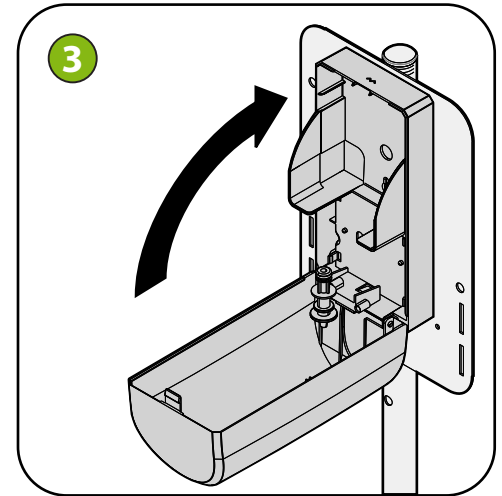
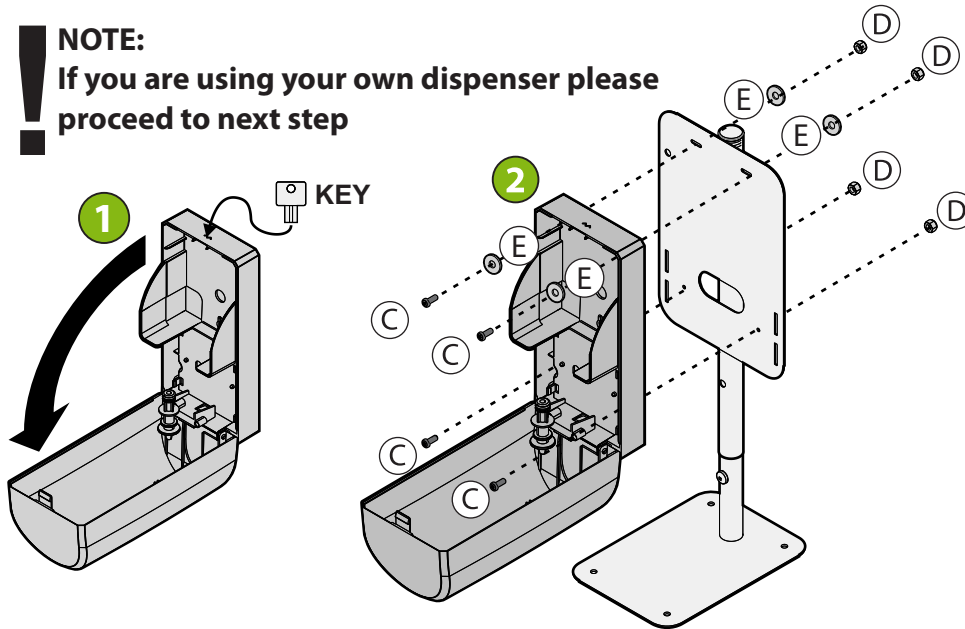

For info on filling your dispenser, please see instructions that came with it

# 2B

You will need: (Not to Scale)

Adhesive Tape  
8x

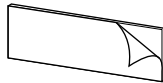

User Provided  
Dispenser  
1x

## Install your own dispenser onto Back Plate

- 1 Peel off backing and press Adhesive Tape Strips onto your dispenser (use as many strips as necessary)
- 2 Peel off 2nd Adhesive Tape Backing
- 3 Press your dispenser firmly against plate for 30 seconds to ensure proper adhesion

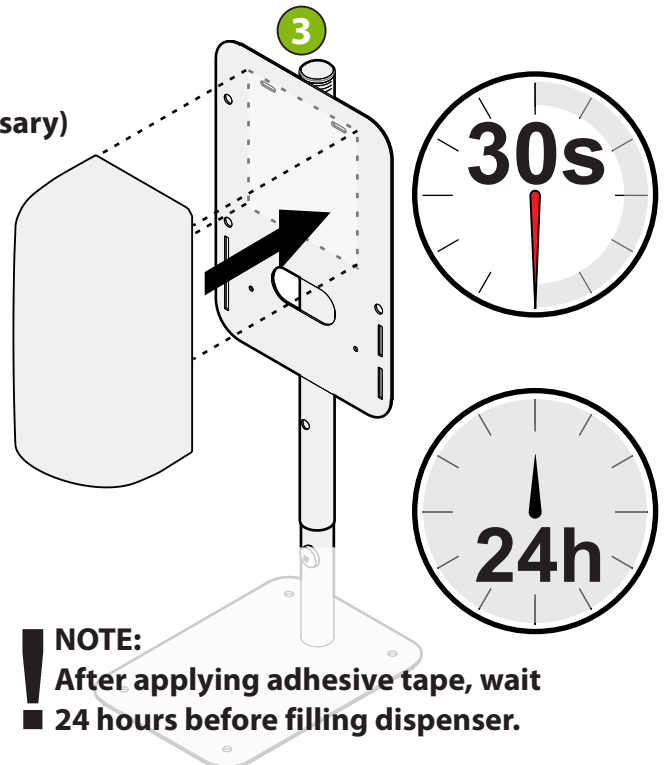
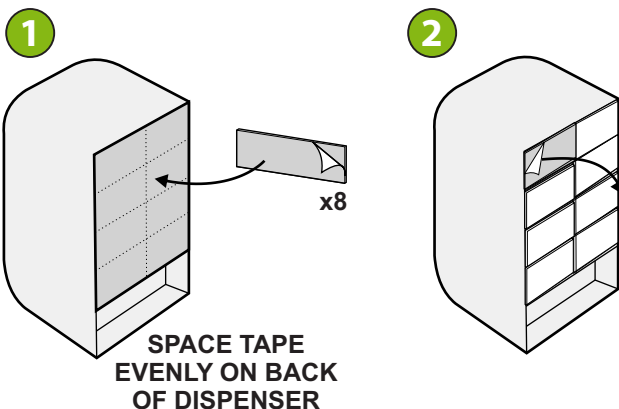

**NOTE:**

After applying adhesive tape, wait 24 hours before filling dispenser.

3

You will need: (Not to Scale)

Child Lockout Safety Feature  
1x

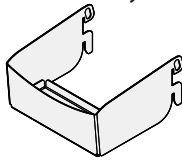

Padlock (NOT INCLUDED)  
1x



The child lock out safety feature prevents students from draining dispensers or ingesting sanitizer. This important feature is not found on generic hand sanitizer dispensers.

## Install Dispenser Lockout into locked or unlocked position

### Dispenser - OPEN

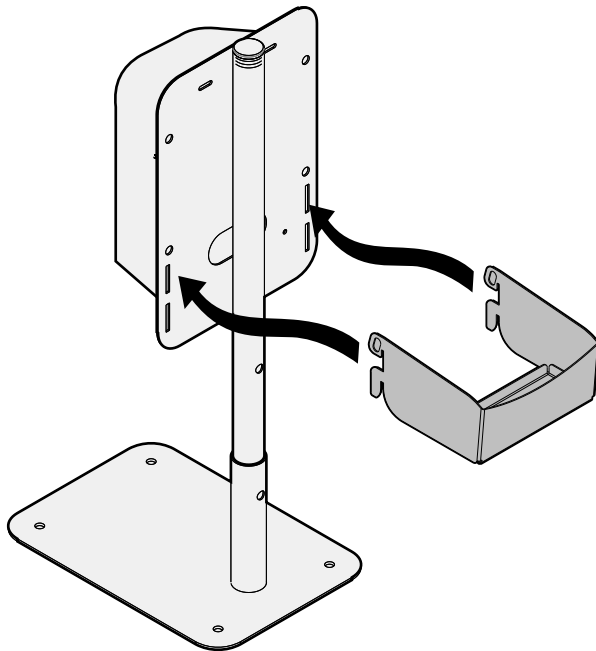

OR

### Dispenser - LOCKED

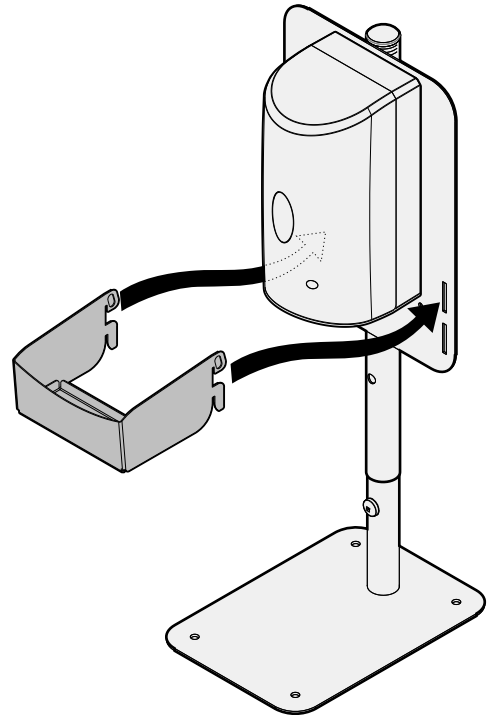

### CHILD LOCKOUT SAFETY FEATURE

