

Double Hand Sanitizer Stand



Assembly Guide SAN200_2020_B

Check out our other products online at
www.copernicused.com

For assistance, please contact us:

1-800-267-8494

Email info@copernicused.com

Have your packing slip ready for reference

WARNING



- This product is meant to be assembled by an adult.
- In its unassembled state, small parts present a hazard.
- To be used under direct supervision of an adult.

★ TIP

Mount entry protocols or instructions on how to sanitize properly on this Sign Plate. It works with magnets!

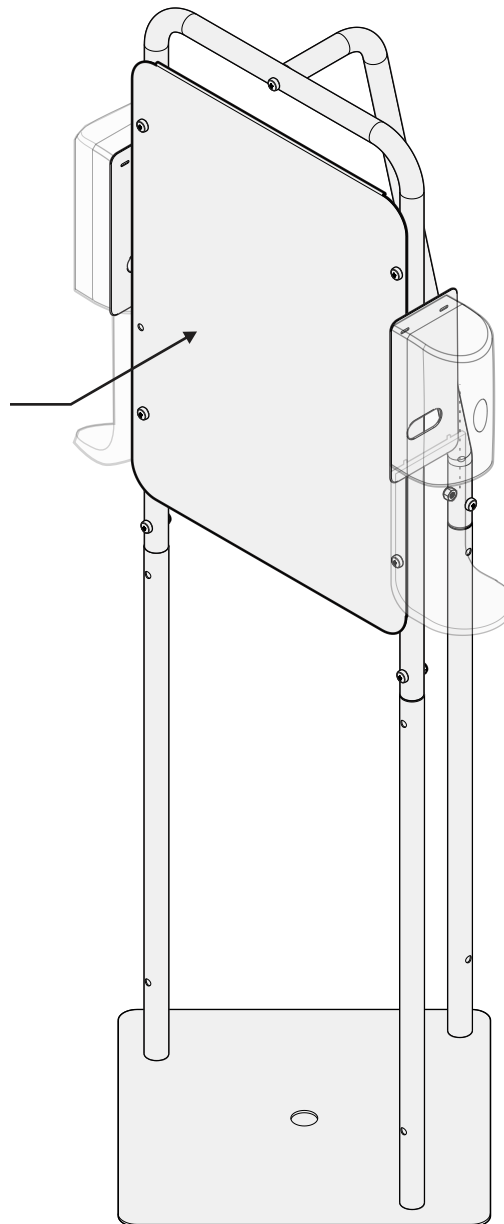

**DISPENSERS SOLD
SEPARATELY
(HSD3)**



Please Recycle

Double Hand Sanitizer Stand



Assembly Guide

SAN200_2020_B

Check out our other products online at
www.copernicused.com

For assistance, please contact us:

1-800-267-8494

Email info@copernicused.com

Have your packing slip ready for reference

Dear Educator,

Thank you for purchasing the Double Hand Sanitizer Stand. We hope it meets all your expectations and you and your students enjoy using it in your school. If you have any questions, concerns or ideas on how we can improve please let us know by contacting our Customer Solutions Ninjas at 1-800-267-8494 or info@copernicused.com.

Happy teaching,

Kaylyn Belcourt
President

Lifetime
All Components
Warranty

Register your Product

Registering your warranty ensures we have all the information we need to make any future warranty claims quick and easy. Please visit www.copernicused.com/warranty and complete the form within 10 business days from product assembly. By registering your product, you will be entered into a draw to win Copernicus product.

Make a Warranty Claim

We offer a Lifetime Warranty on almost everything we make. Please call 1-800-267-8494 or email info@copernicused.com to start your warranty claim. Proof of purchase will be required upon warranty claim (i.e. copy of invoice).



Warning! Hazard Risks!

Please read the warnings below for important safety information regarding your product. Failure to read these warnings or to follow the instructions below could result in personal injury or damage to your product that could void your warranty.



**Adult
Supervision**

This product is to be used under the supervision of an adult.



**Small
Parts**

In its unassembled state, this product contains parts that can be hazardous to small children. This product should be assembled by an adult.

Customer Service - FAQ's



For any issues:

Please call Copernicus Customer Service, where we will be happy to help.

1-800-267-8494. Monday - Friday 8:00am - 4:30 pm EST.

Email our Customer Support Service at info@copernicused.com

**Check out some of our
other great products!**



www.copernicused.com

Double Hand Sanitizer Stand

Before beginning, you should have:

Additional tools required:



Adjustable wrench 2x

OR

8mm
11mm (2x)



Rubber Mallet 1x



Screwdriver

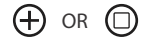

SAN200

Sign Plate
(32287)

1x

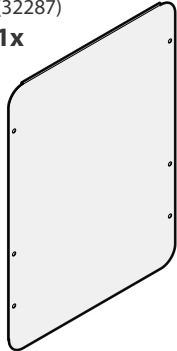

Rear Tube Brace
(33179)

1x



Upper Tube
(33177)

1x

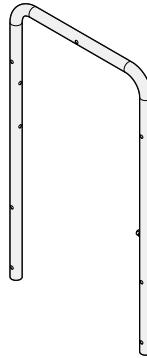

Bottom Tube
(55107)

3x



Dispenser Mounting Plate
(32289)

2x



Square Base
(32288)

1x

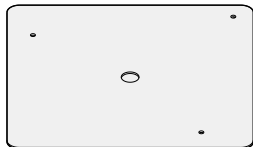

Adhesive Tape
(700013)

16x

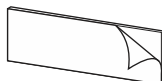

In Box 1

Hardware Actual Size

(A) 1/4-20 x 1-1/4" Flat Head Screw
(430043)

3x



(B) 1/4-20 x 1-1/2" Pan Head Screw
(43006)

1x



(C) 1/4-20 x 1-1/4" Pan Head Screw
(43005)

7x



(D) 1/4-20 Kepps Nut
(4301621)

11x



(E) 1/4" Split Lock Washer
(43010)

1x



(F) 6-32 x 3/8" Pan Head Screw
(4301352)

8x



(G) 6-32 Hex Nut
(430164)

8x



(H) 11/64" Flat Washer
(4301902)

8x



HSD3 SOLD SEPARATELY

Dispenser and
Drip Tray
(HSD3)

1x

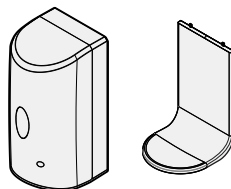

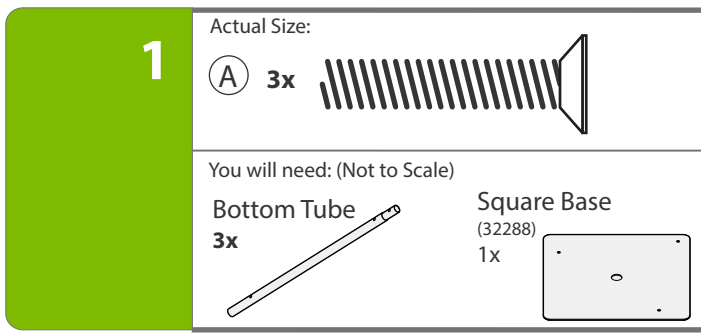

Assemble Bottom Tubes to Square Base

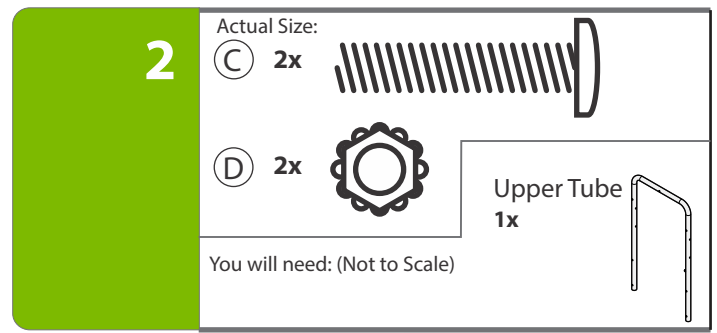
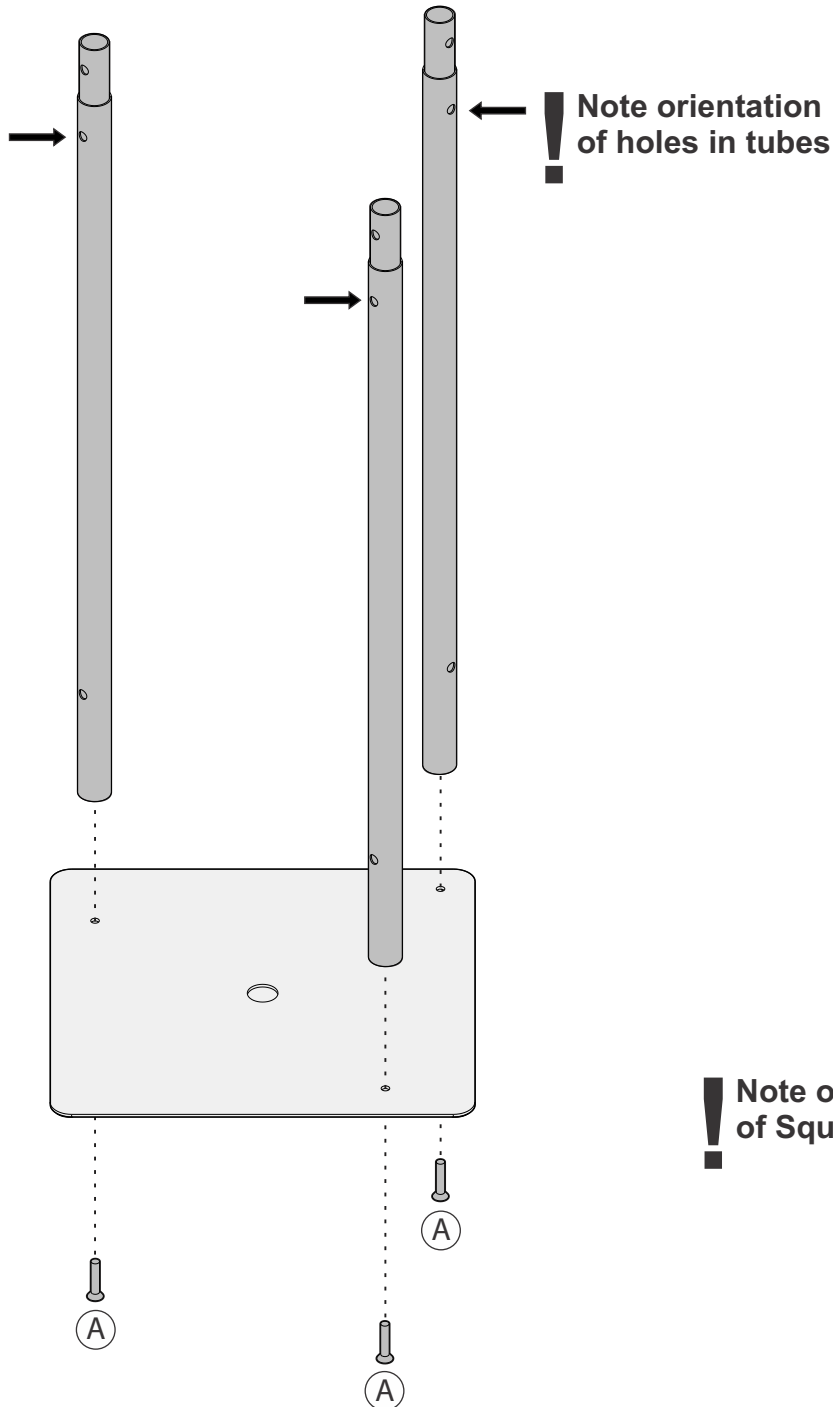

Attach Upper Tube to Bottom Tubes

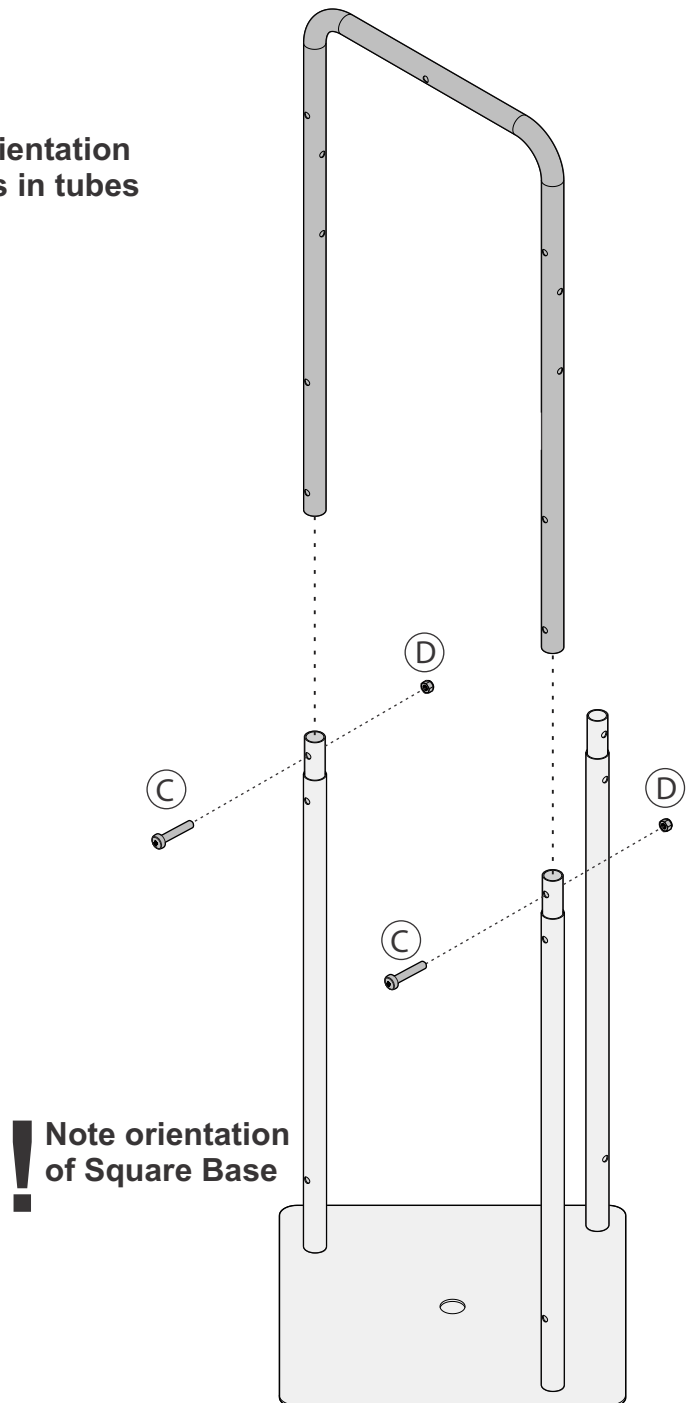

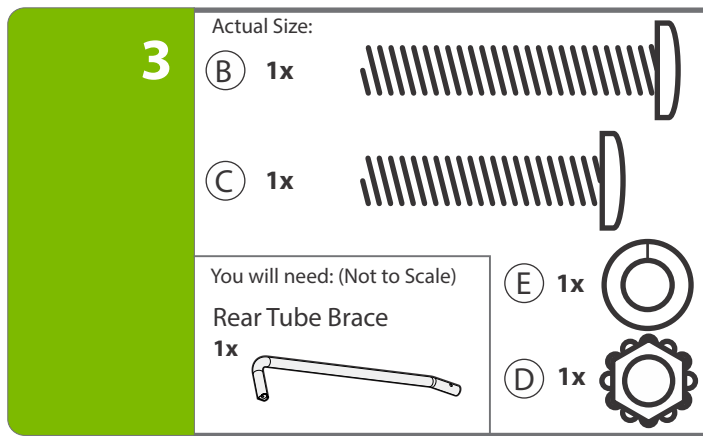

Attach Rear Tube Brace

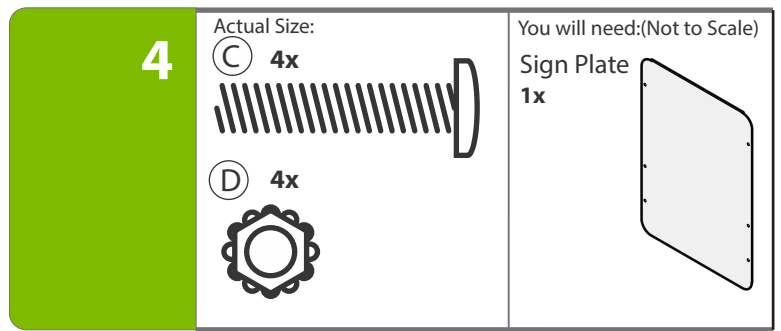
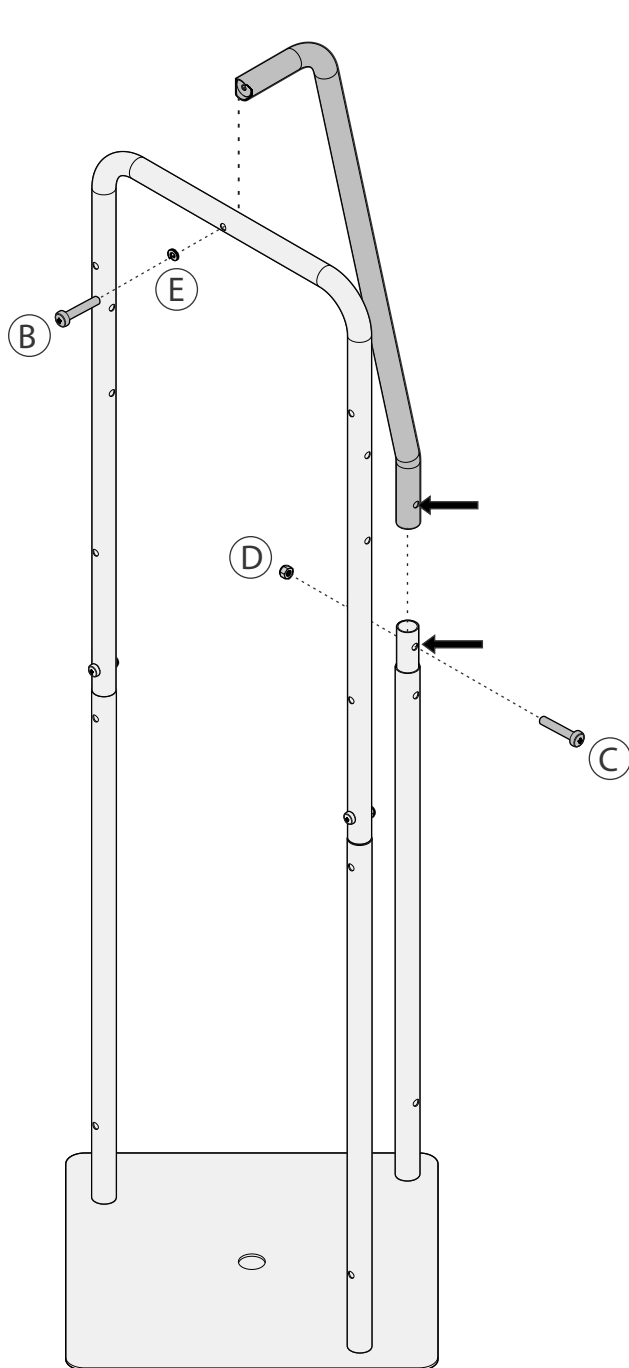

Attach Sign Plate to Upper Tube

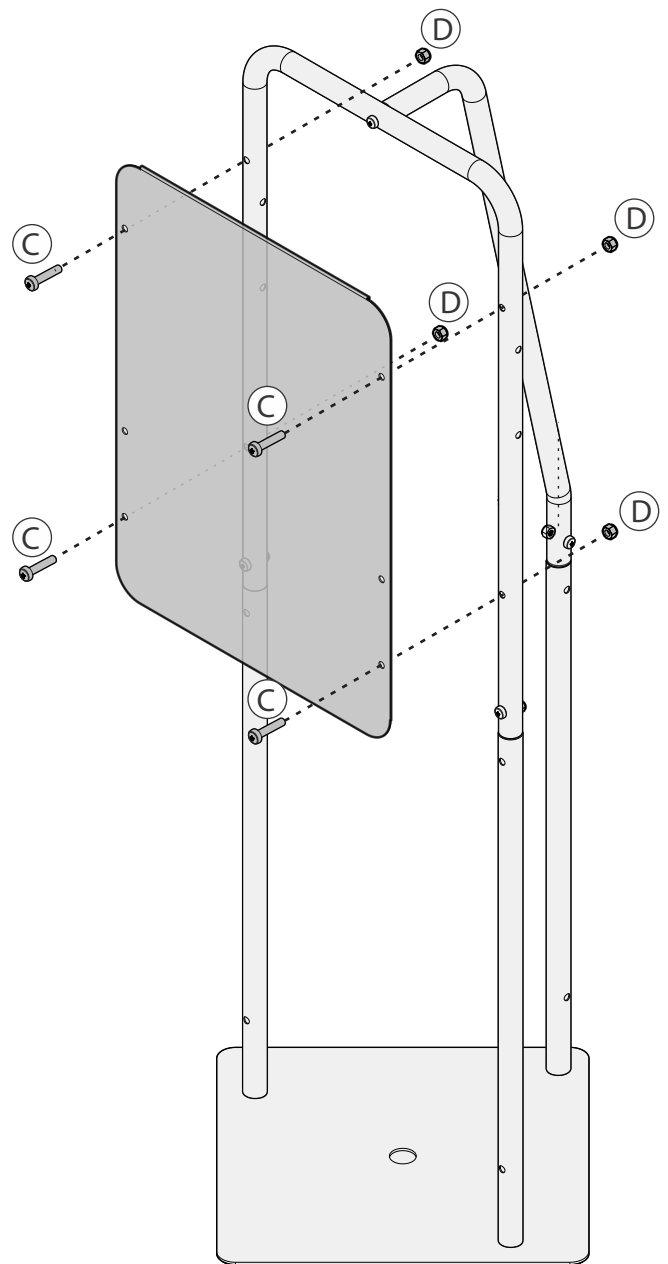

5

Actual Size:

(D) 4x



You will need: (Not to Scale)

Dispenser Mounting Plate
(32289)

2x



Attach Dispenser Mounting Plates

Note
Large hole on plate
should be on the bottom

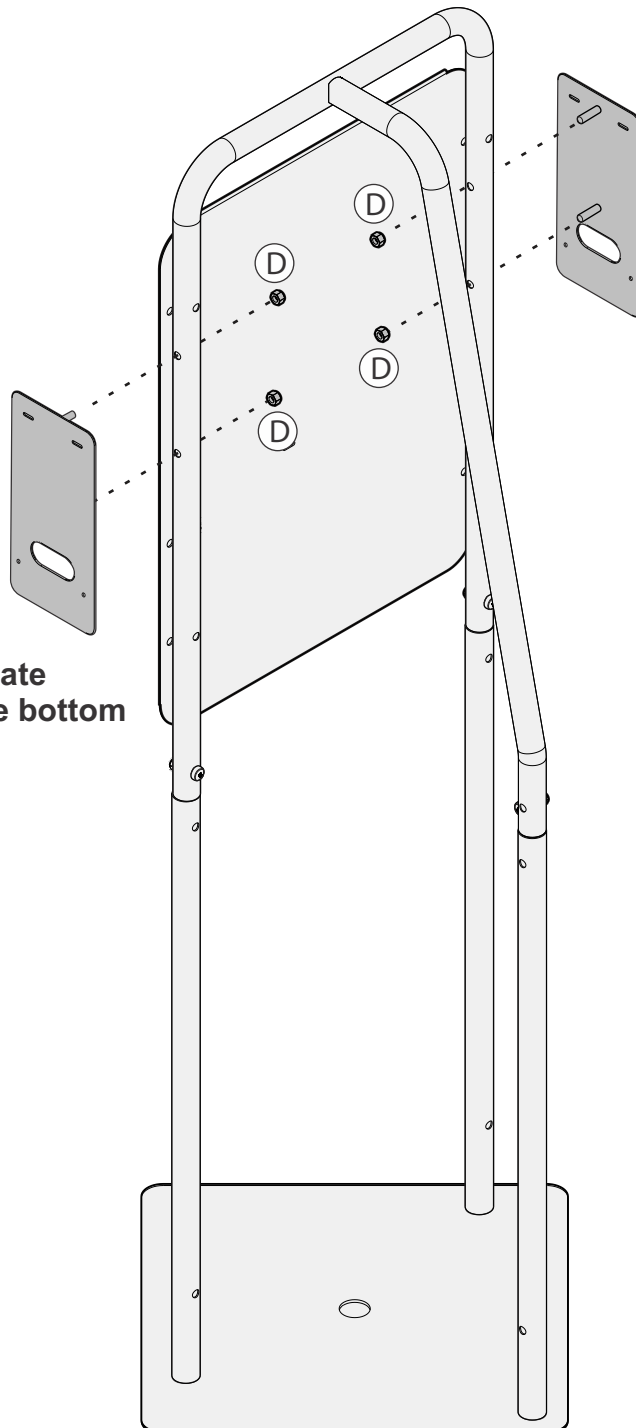

Note
Large hole on plate
should be on the bottom

6A

Actual Size:



H 8x

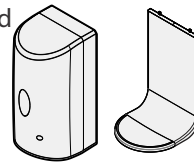

You will need: (Not to Scale)

SOLD SEPARATELYDispenser and
Drip Tray
(HSD3)
2x

Install Dispenser onto Back Plate

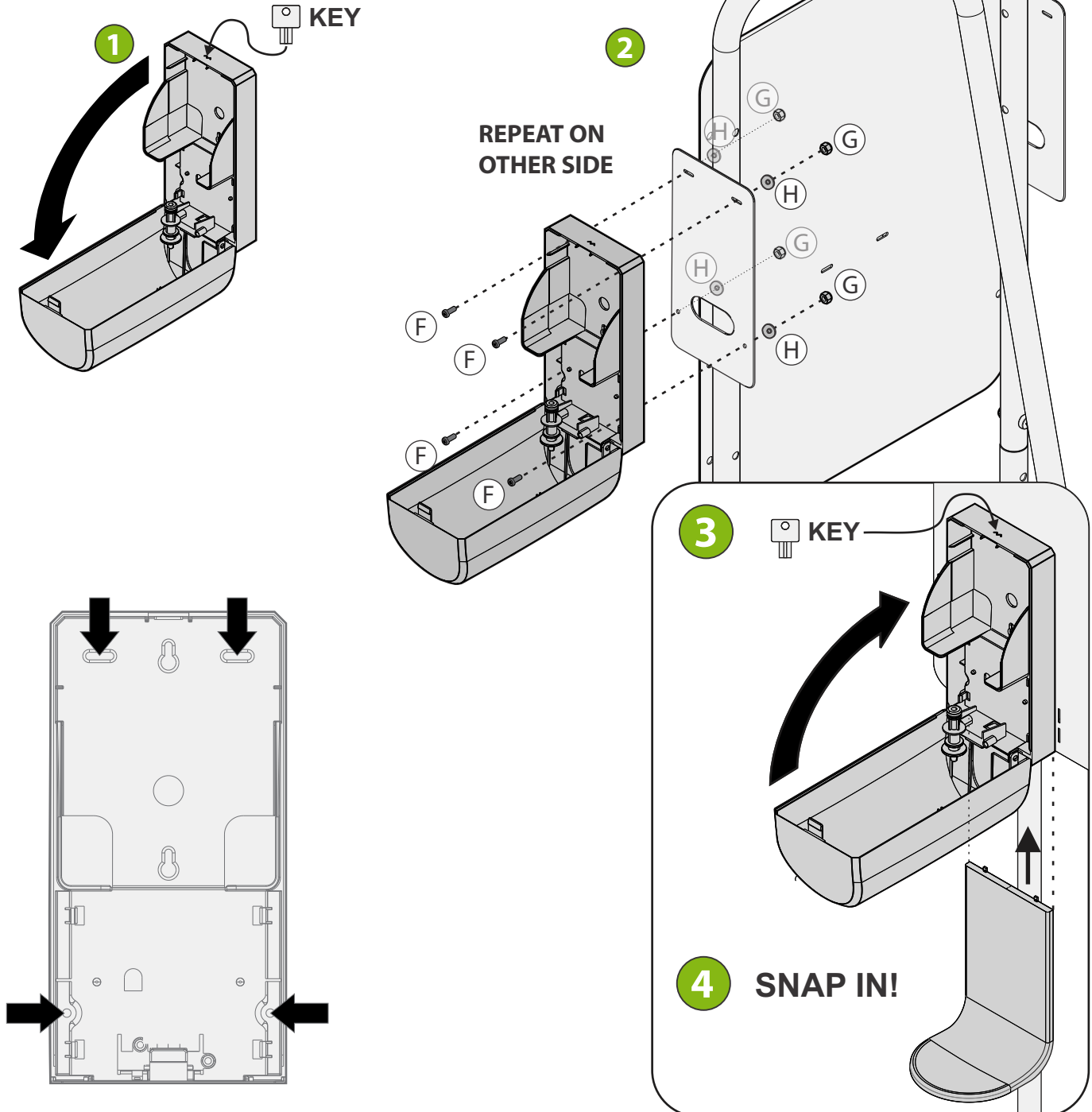
NOTE:**If you are using your own dispenser please
proceed to next page****See dispenser instructions for how to fill dispenser**

Install your own dispenser onto Back Plate

- 1** Peel off 1 side of Adhesive Tape backing



- 2** Press Adhesive Tape onto your dispenser (use as many strips as necessary)

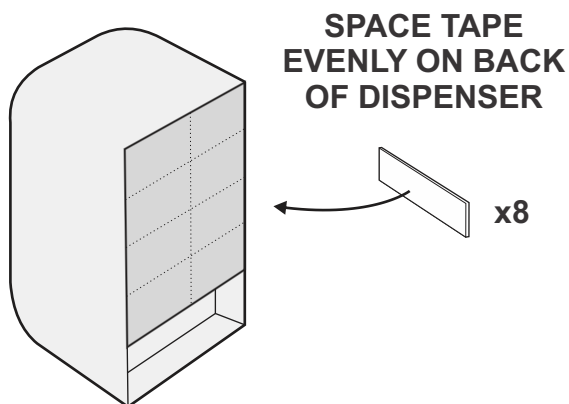

- 3** Peel off all remaining Adhesive Tape Backing

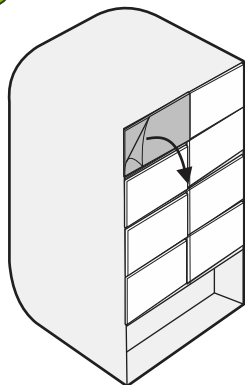

- 4** Press your dispenser firmly against Back Plate for 30 seconds to ensure proper adhesion

