



Assembly Guide

Check out our other products online at www.copernicused.com

For assistance, please contact us by telephone at **1-800-267-8494** or email at info@copernicused.com.

Have your packing slip ready for reference.

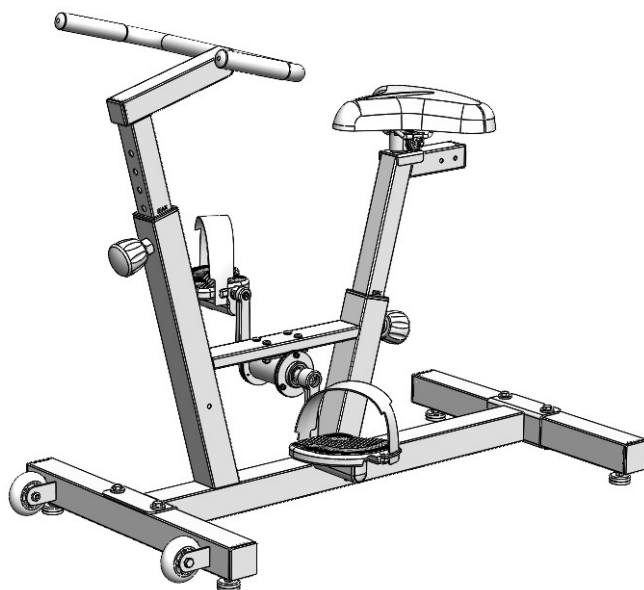

Self-regulation Classroom Bike - Base Grades PreK-2 - (SCC302)
Self-regulation Classroom Bike - Base Grades PreK-2 (Green) - (SCC302-G)

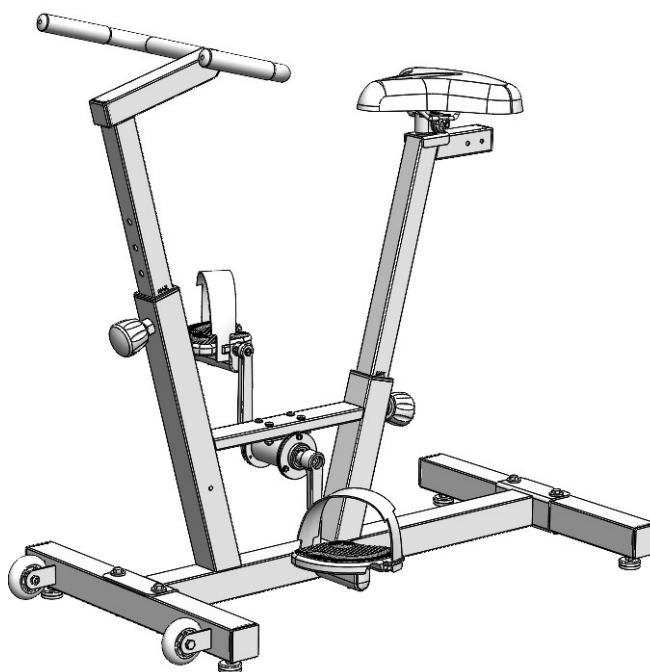

Self-regulation Classroom Bike - Base Grades 3-6 - (SCC402)
Self-regulation Classroom Bike - Base Grades 3-6 (Green) - (SCC402-G)



Customer Service & Warranty Information

Dear Educator,

Thank you for purchasing the Self-regulation Classroom Bike. We hope it meets your expectations and you and your students enjoy using it at your school.
Every day we see and hear stories of teachers going above and beyond to help students thrive. Thank you so much for all you do – you are awesome, and you make a difference.
Thank you for inspiring us.

If you have any questions, concerns or ideas on how we can improve please let us know by contacting our Customer Service team at 1-800-267-8494 or info@copernicused.com.

Happy teaching,

Kaylyn Belcourt, President
kaylyn@copernicused.com



We do not inherit the earth
from our ancestors, we
borrow it from our children.

- NATIVE AMERICAN PROVERB

Change is the end result of all
true learning.

- LEO BUSCAGLIA

What you leave behind is not
what is engraved in stone
monuments, but what is
woven into the lives of others.

- PERICLES

Education is the most
powerful weapon which you
can use to change the world.

- NELSON MANDELA

For missing parts and other issues regarding your product:

Please contact Customer Service, where we will be happy to help.
Telephone: 1-800-267-8494, Monday - Friday 8:00am - 4:30 pm EST
Email: info@copernicused.com

**Need Support?
Have a Question?**



Email [Customer Service](mailto:info@copernicused.com)

**Check out some of our
other great products!**



www.copernicused.com



Register your Product

Registering your warranty ensures we have all the information we need to make any future warranty claims quick and easy. Please visit www.copernicused.com/warranty and complete the form within 10 business days from product assembly. By registering your product, you will be entered into a draw to win Copernicus product.



Make a Warranty Claim

We offer a Lifetime Warranty on almost everything we make. Please call **1-800-267-8494** or email info@copernicused.com to start your warranty claim. Proof of purchase will be required upon warranty claim (i.e. copy of invoice).

Tips for Assembly

Before You Begin:

- Lay out and identify all of the included parts.
- The hardware has been packed according to step.
- Read the assembly guide over once to familiarize yourself with them.

As You Assemble the Unit:

- Follow the steps in sequence.
- Before beginning each step, find the part(s) that you need for that step.
- The title of each step states what you will be doing. Review the text and the pictures as you build the unit.

Watch for These Helpful Symbols:



2-Person Task

For safety, please have someone help you when working on steps displaying this symbol.



The symbol denotes a step needing extra attention to ensure it is done correctly.



Important Information! Warning!

Please read the warnings below for important safety information regarding your product. Failure to read these warnings or to follow the instructions below could result in personal injury or damage to your product that could void your warranty.



Small Parts

In its unassembled state, this product contains parts that can be hazardous to small children. This product should be assembled by an adult.



Adult Supervision

This product is to be used under the supervision of an adult.



Indoor Use Only

This product is intended for indoor commercial use only. The internal components are not sealed from the environment.

INSTALLATION

Minimum clearance required around equipment for access to, passage around and emergency dismount. Minimum dimensions are 0.5m (19.7in) on at least one side and 0.5m (19.7in) either behind or in front of the bike.

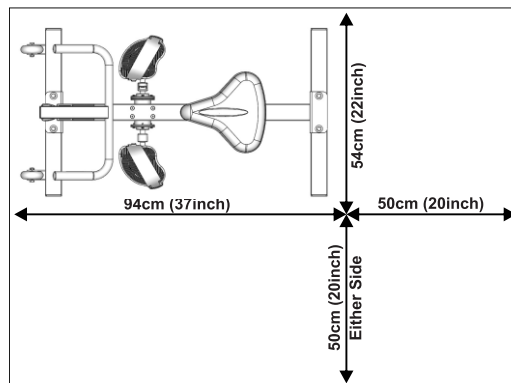

Actual area for access/passage is the responsibility of the facility and should take into account this training envelope, ADA Accessibility Guideline requirements and any required local codes or regulations.

BEFORE USING

1. As with all exercise equipment or programs, consult a physician prior to use and stop if you feel faint, dizzy or exhausted.
2. The equipment should only be used in a supervised environment.
3. The equipment must be set up and operated on a solid, level surface.
4. A complete visual inspection and test of the features and functions of the assembled Self-regulation Classroom Bike is to be made prior to use. Immediately report worn, loose or damaged equipment to the teacher and refrain from using the bike.
5. Keep body and clothing free and clear of all moving parts.
6. Ensure all adjustments and locking features are properly secured before using bike.
7. No adjustment should be made, which may limit the movements of the user.
8. This equipment is not intended for athletic training purposes.

9. Maximum user capacity is 143lbs/ 65kgs

How to Adjust Seat and Handle Bar Height

SCC302 / SCC302-G Base Grades PreK-2 4-8 Year Olds

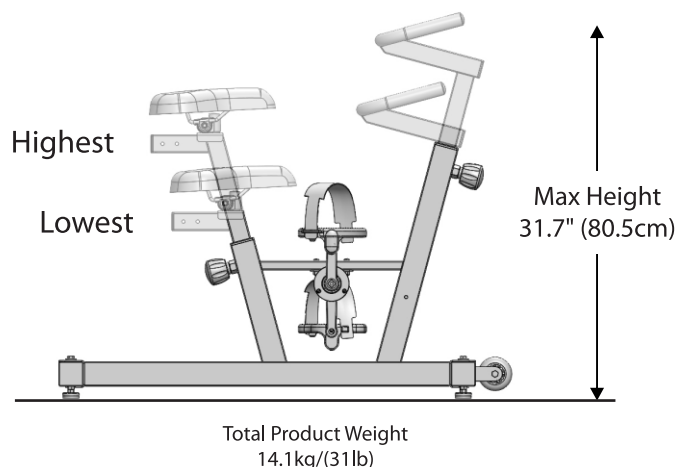

SCC402 / SCC402-G Base Grades 3-6 6-12 Year Olds

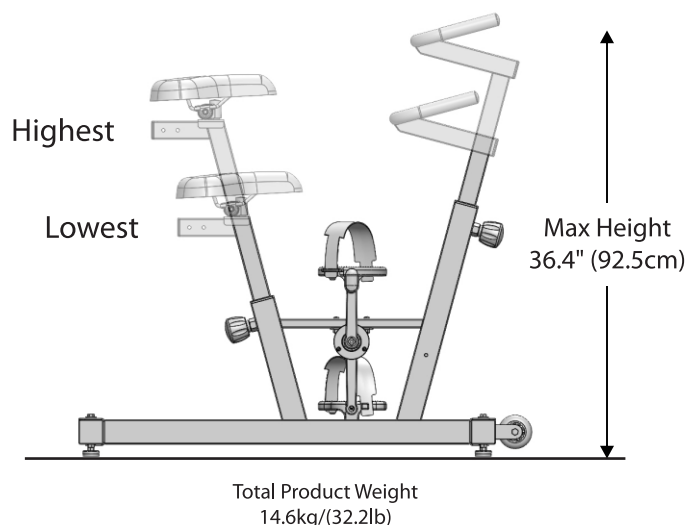

! Warning! Do not pedal backwards for a prolonged period of time. This can lead to possible injury and damaged parts. Refer to "Tips" page at the back of this manual for more info.

How to Adjust Handle Bar Post

To adjust the handle bar height, first turn the knob counter-clockwise approximately 3 turns to loosen it.

Next, pull the knob, slide the post up or down to the desired position, and then release the knob.

Move the post up or down slightly until you feel a pop, to make sure that the knob is engaged in one of the adjustment holes in the seat post. Then, turn the knob clockwise to tighten it firmly.

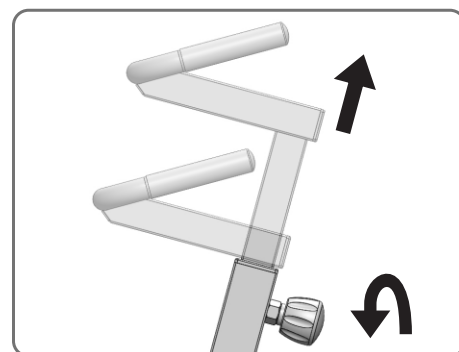

How to Adjust Seat Post and Saddle Position

To adjust the seat, first turn the height adjustment knob counter-clockwise approximately 3 turns to loosen it.

Next, pull the knob, slide the seat post up or down to the desired position, and then release the knob.

Move the post up or down slightly until you feel a pop, to make sure that the knob is engaged in one of the adjustment holes in the seat post. Then, turn the knob clockwise to tighten it firmly.

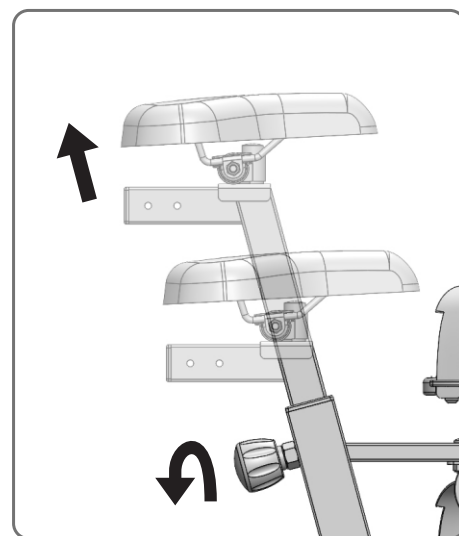

Parts

Before beginning, you should have:

Additional tools required:

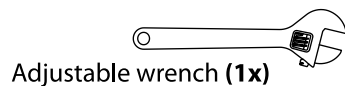

OR

1/2" or 13mm (1x),
15mm (2x)

+

Screwdriver #2 OR #3

⊕ OR ⊖

Frame
(D001-321)
1x

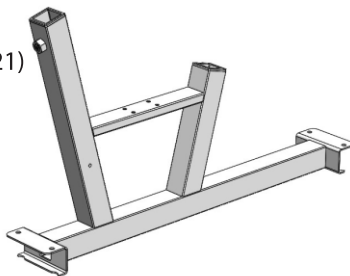

Seat
(ZSCC-21128)
1x



Front Foot
(D001-324)
1x

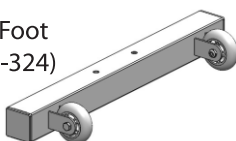

Back Foot
(32382)
1x

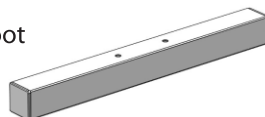

In Box

Hardware
Actual Size

(A) 5/16" x 2-3/4" Screw
(43009211)
4x



(B) 1/4" x 1-1/4" Screw
(430511)
4x



(C) 1/4" Lock Nut
(430101)
4x



(D) 5/16" Lock Nut
(430104)
4x

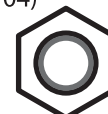

(E) 1/4" Washer
(43019)
4x



(F) 5/16" Washer
(430197)
8x



Leveling Foot- NOT TO SCALE
(ZSCC-43005)
4x

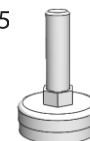

Height Adjustment Knob - NOT TO SCALE
(ZSCC-43001)
2x



SCC302:

Handlebars
Small
(D001-307)
1x

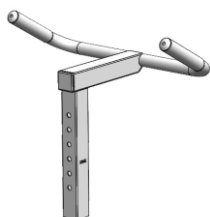

Seat Post Small
(32136)
1x

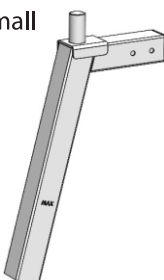

Pedal Pre-Assembly
Small
1x

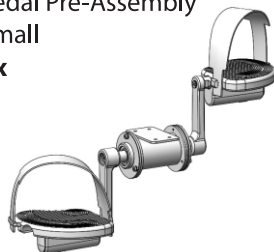

SCC402:

Handlebars
Large
(D001-305)
1x

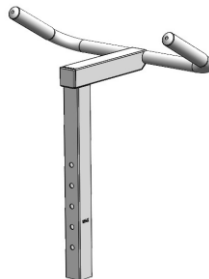

Seat Post Large
(32138)
1x

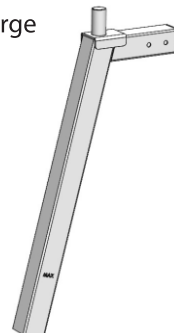

Pedal Pre-Assembly
Large
1x



OR

1

You will need: (Not to Scale)

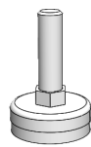

Leveling Foot
4x

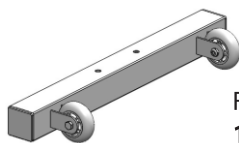

Front Foot
1x

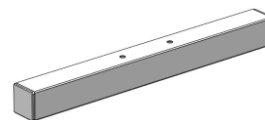

Back Foot
1x

Install Leveling Feet

! Thread in feet
all the way

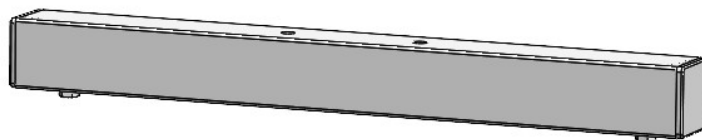
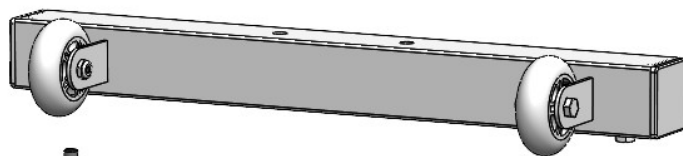

2

Actual Size:



A
4x



D
4x



F
8x

You will need: (Not to Scale)

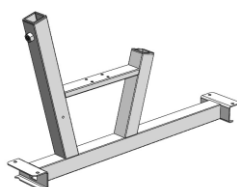

Frame
1x

Install Feet on Frame

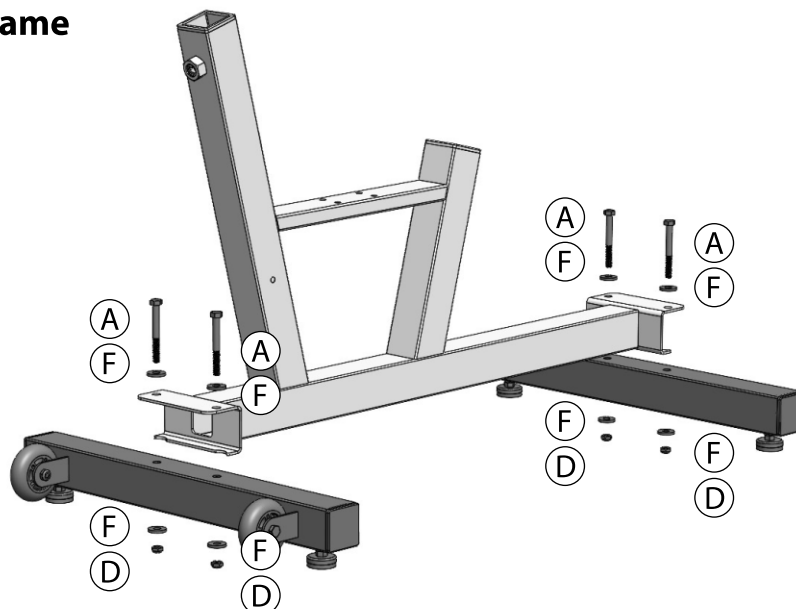

! Tighten
all bolts

3

Actual Size:



You will need: (Not to Scale)

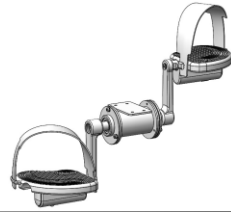

Pedal Assembly
1x

Install Pedal Assembly

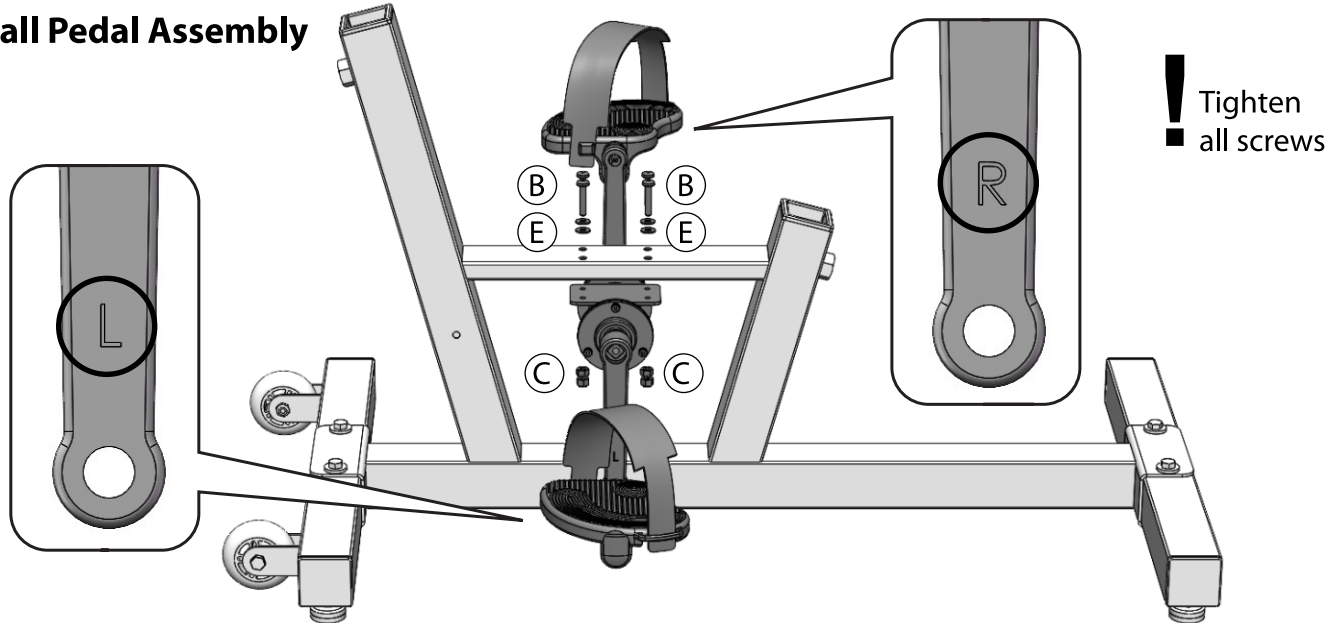

4

You will need: (Not to Scale)

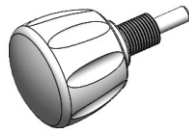

Height Adjustment Knob
2x

Install Height Adjustment Knobs

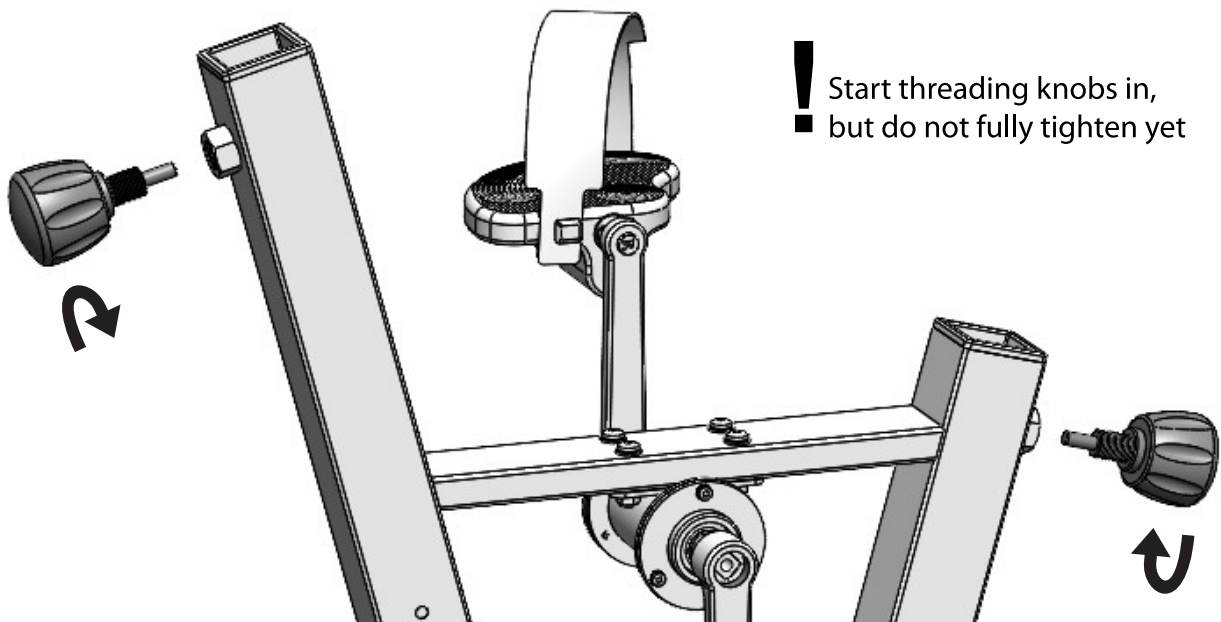

5

You will need: (Not to Scale)

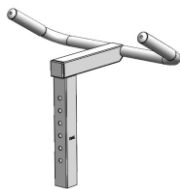

Handlebars
1x

Install Handlebars

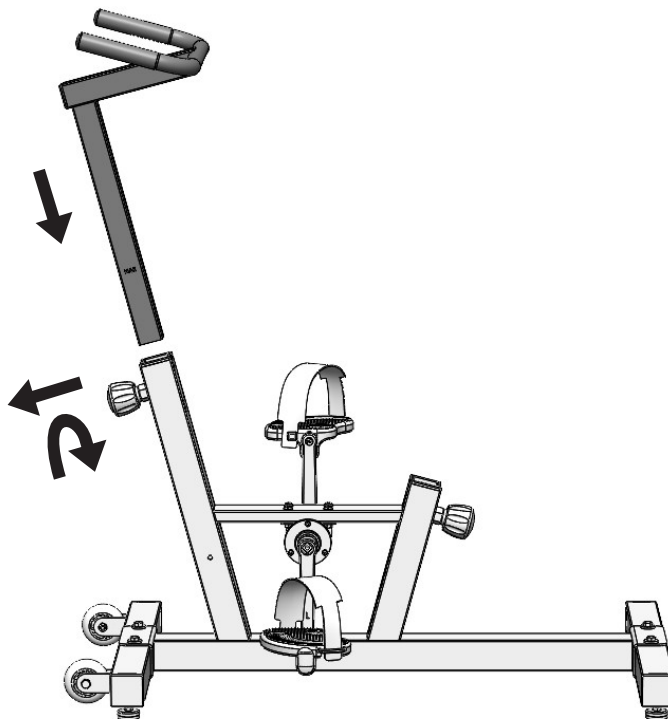

6

You will need: (Not to Scale)

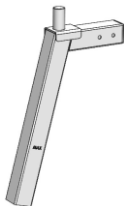

Seat Post
1x

Install Seat Post

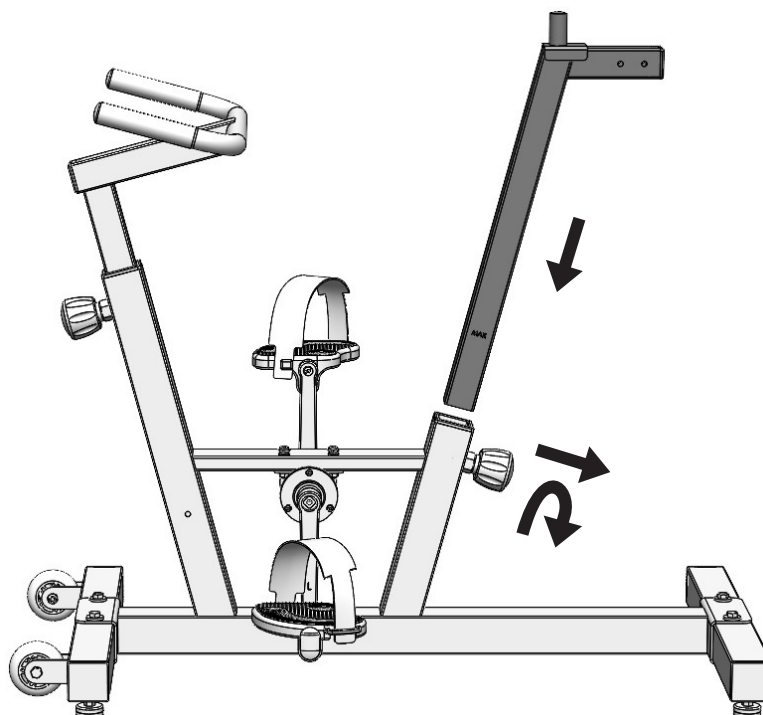

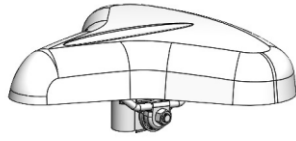
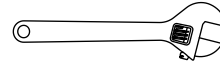
Seat
1x

Adjustable wrench (1x)

OR

1/2" / 13mm Wrench (1x)

Install Seat

- 1 Loosen hardware on either side of saddle before attaching to seat post.

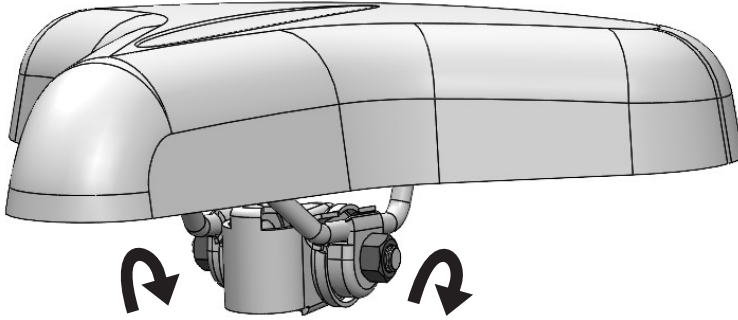

- 2 Slide saddle over post.

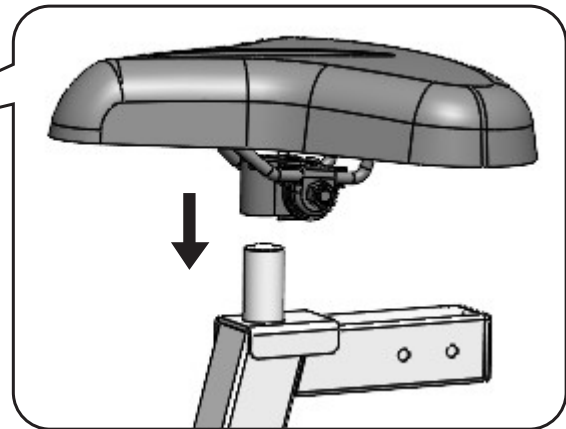
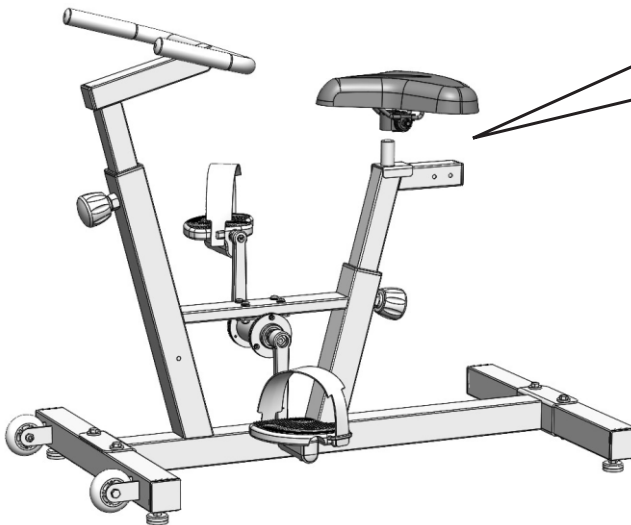

- 3 Ensure the saddle is positioned horizontally and tighten hardware.

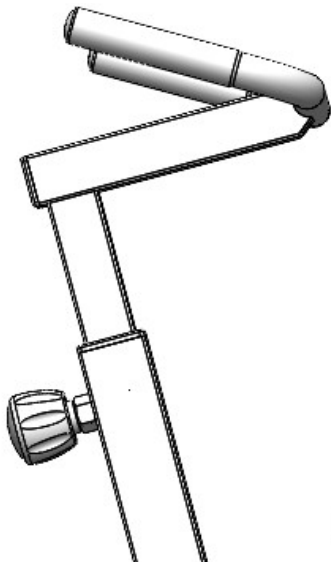

! Make sure saddle is tight enough on the seat post by pushing down on front and back. Tighten more if needed.

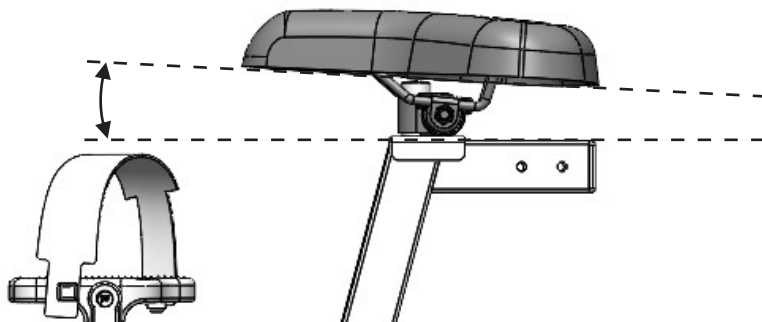

Comfortable Riding Position Tips

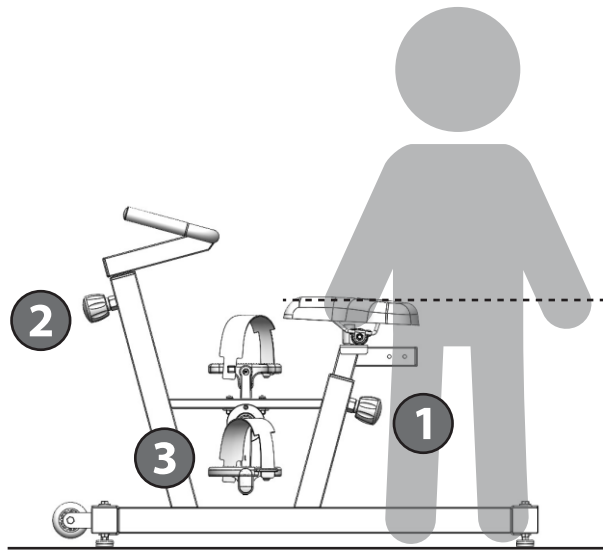

Each rider should adjust to their own comfortable riding position.

- 1** Adjust seat to the height of your hip bone.
- 2** You should be able to reach the handlebars easily, keeping your elbows slightly bent.
- 3** To tighten a pedal strap, pull upward on the end of the strap to release tab from slot. Move strap to desired slot, press the tab through strap to secure.

How To Safely Move Your Classroom Bike

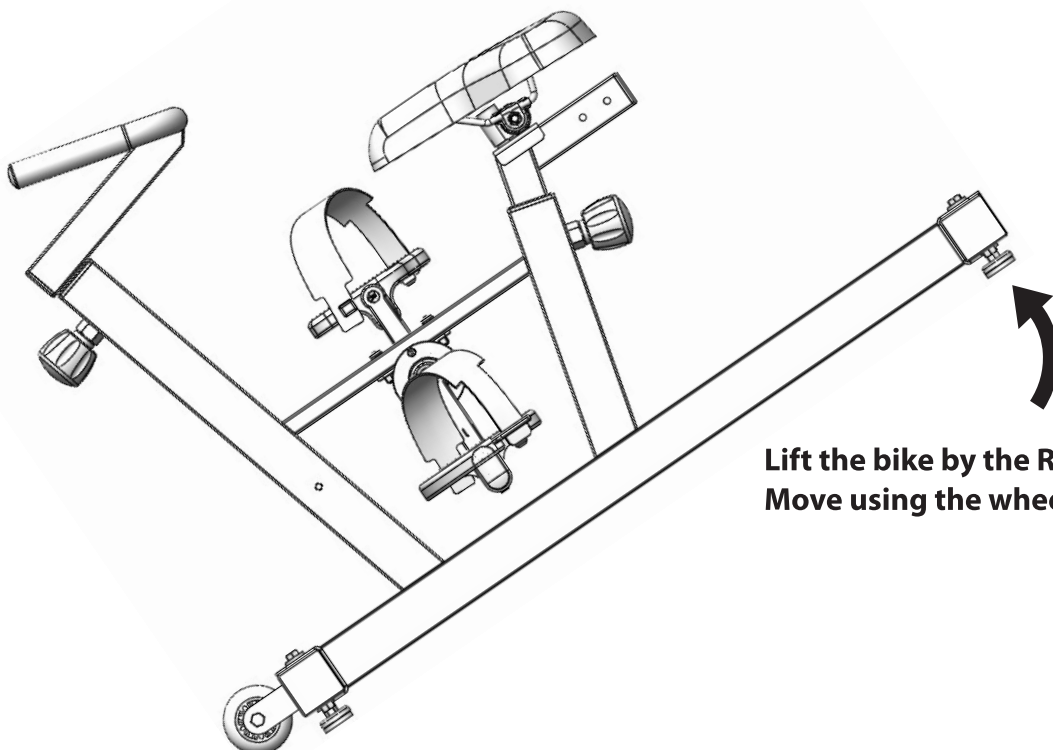

**Lift the bike by the Rear Foot.
Move using the wheels on the Front Foot.**