

BC300-EXT

Complete Outdoor Classroom Cart



Assembly Guide BC300-EXT_2021_A

Check out our other products online at
www.copernicused.com

For assistance, please contact us:

1-800-267-8494

Email info@copernicused.com

Have your packing slip ready for reference

WARNING



- This product is meant to be assembled by an adult.
- In its unassembled state, small parts present a hazard.
- To be used under direct supervision of an adult.

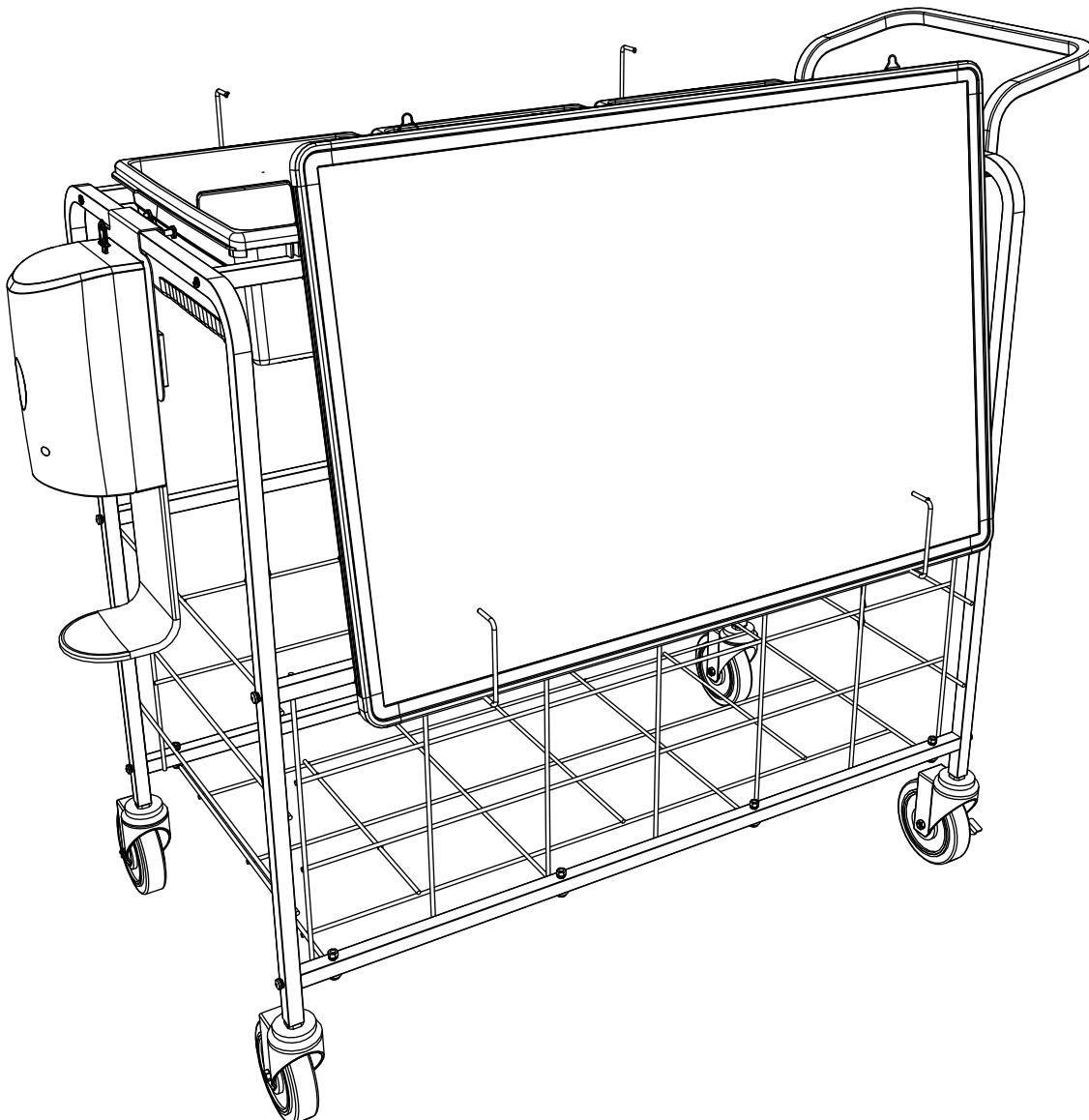

Please Recycle

Complete Outdoor Classroom Cart



Assembly Guide

BC300-EXT_2021_A

Check out our other products online at
www.copernicused.com

For assistance, please contact us:

1-800-267-8494

Email info@copernicused.com

Have your packing slip ready for reference

Dear Educator,

Thank you for purchasing the Complete Outdoor Classroom Cart. We hope it meets all your expectations and you and your students enjoy using it in your school.

If you have any questions, concerns or ideas on how we can improve please let us know by contacting our Customer Solutions Ninjas at 1-800-267-8494 or info@copernicused.com.

Happy teaching,

Kaylyn Belcourt
 President

We do not inherit the earth from our ancestors, we borrow it from our children.

Change is the end result of all true learning.

LEO BUSCAGLIA

What you leave behind is not what is engraved in stone monuments, but what is woven into the lives of others.

Education is the most powerful weapon which you can use to change the world.

NELSON MANDELA

NORTH AMERICAN

PROVERB

PERICLES

Lifetime

Tub/Frame
 Warranty

Register your Product

Registering your warranty ensures we have all the information we need to make any future warranty claims quick and easy. Please visit www.copernicused.com/warranty and complete the form within 10 business days from product assembly. By registering your product, you will be entered into a draw to win Copernicus product.

5

Year

Whiteboard
 Warranty

Make a Warranty Claim

We offer a Lifetime Warranty on almost everything we make. Please call 1-800-267-8494 or email info@copernicused.com to start your warranty claim. Proof of purchase will be required upon warranty claim (i.e. copy of invoice).

1

Year

Sanitizer
 Dispenser
 Warranty

Replace your Whiteboard

Have a well-used whiteboard that needs replacing? Our whiteboards carry a five-year warranty and replacement parts program after the warranty period. Please call 1-800-267-8494 or email info@copernicused.com to get a new whiteboard for your Copernicus product!



Warning! Hazard Risks!

Please read the warnings below for important safety information regarding your product. Failure to read these warnings or to follow the instructions below could result in personal injury or damage to your product that could void your warranty.



**Small
Parts**

In its unassembled state, this product contains parts that can be hazardous to small children. This product should be assembled by an adult.



**Adult
Supervision**

This product is to be used under the supervision of an adult.



**Indoor Use
Only**

This product is intended for indoor use only. To reduce the risk of fire or electric shock, do not expose this product to rain or moisture. The internal components are not sealed from the environment.



Climb Hazard

Do not climb on, hang from or suspend objects from any components of your product unless otherwise specified.

Complete Outdoor Classroom Cart

Before beginning, you should have:

Additional tools required:



OR

10mm
Wrench



Rubber Mallet 1x

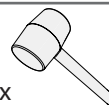

BC300-EXT-0

End Frame

2x

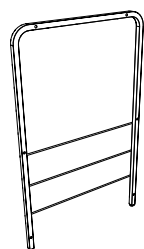

Stretcher

2x



Wire Rack

1x



Rack Hook

2x



Ball Rack Bottom Frame

1x

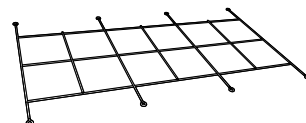

Ball Rack Side Frame

2x

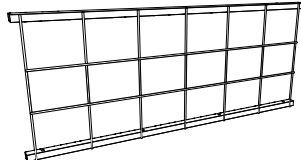

Hardware Actual Size

(A) M6 x 45mm
12x
(43245)



(B) M6 x 30mm
8x
(43230)



(C) M6 Lock Washer
20x
(43273)



(D) M6 Lock Nut
8x
(43275)



(E) M6 Acorn Nut
2x
(43271)



(F) M6 Flat Washer
2x
(432731)



Tools (Not to Scale)

Allen Key
(43281)
1x

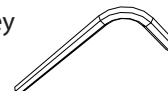

BC300-EXT-CB

Dispenser Mounting
Bracket
2x

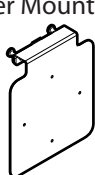

Handle
1x

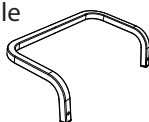

Open Tub
3x
(Cc4068)

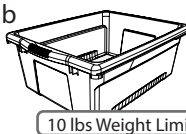

10 lbs Weight Limit

Hand Sanitizer Dispenser
and Drip Tray
HSD3
2x

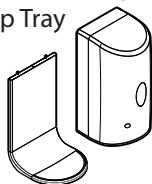

Rack Hook
2x



Casters

4x
2x locking
2x non-locking



Lined Magnetic
Dry Erase Board
x1
(AC455)

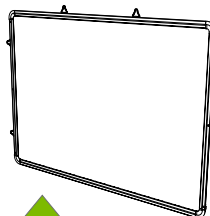

Wire Rack
1x



Hardware Actual Size

(G) 1/4" -20 x 1/2" Hex Screw
(4302041)
2x



(H) 6-32 x 3/8" Pan Head Screw
(4301352)
6x



(I) 6-32 Hex Nut
(430164)
4x



(J) 11/64" Flat Washer
(4301902)
4x



(K) 3/8" Flat Washer
(4301913)
2x



(L) #6-32 Keps Nut
(430154)
2x



Tips for Assembly

Watch for These Helpful Symbols

This symbol denotes a 2-Person Task. For safety, please ensure that there are the suggested number of people working on steps displaying this symbol.



Watch for this symbol throughout the Assembly Guide. Wherever you see it, pay close attention. The symbol denotes a step needing extra attention to ensure it is done correctly.



The star symbol highlights an advisory note.



Before You Begin

- Lay out and identify all of the included parts.
- The hardware has been packed according to step.
- Read the assembly guide over once to familiarize yourself with them.



! Please note that in its unassembled state, this product contains parts that can be hazardous to small children. This product should be assembled by an adult.

As You Assemble the Unit

- Follow the steps in sequence.
- Before beginning each step, find the part(s) that you need for that step.
- Pay attention to the labels on the parts; they are there to help direct you at certain stages.
- The title of each step states what you will be doing. Review the text and the pictures as you build the unit.

Customer Service - FAQ's



For missing parts and other issues regarding the frame:

Please call Copernicus Customer Service, where we will be happy to help.

1-800-267-8494. Monday - Friday 8:00am - 4:30 pm EST.

OR

Email our Tech Support Service at info@copernicused.com

**Need Tech Support?
Have a Question?**



Email our Tech Support Service

**Check out some of our
other great products!**



www.copernicused.com

1

You will need: (Not to Scale)

Casters
2 x locking
2 x non-locking

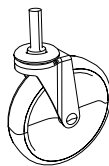

End Frame
2x



Insert Casters into Both End Frames



Use a rubber mallet to tap the casters into the bottom of the frame

Install 1 x locking and 1 x non-locking locking caster on each frame

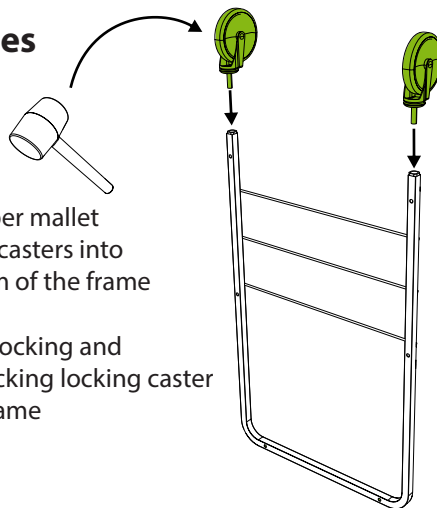

2

Actual Size:

(A) M6 x 45mm
12x



(C) M6 Lock Washer
12x



You will need:
(Not to Scale)

Ball Rack Side Frame
2x

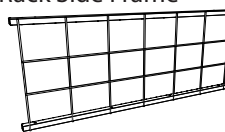

End Frame (with casters installed)
2x

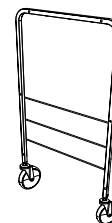

Stretcher
2x

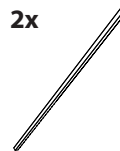

2-Person Task

Assemble Ball Rack Side Frames and Stretchers to End Frames

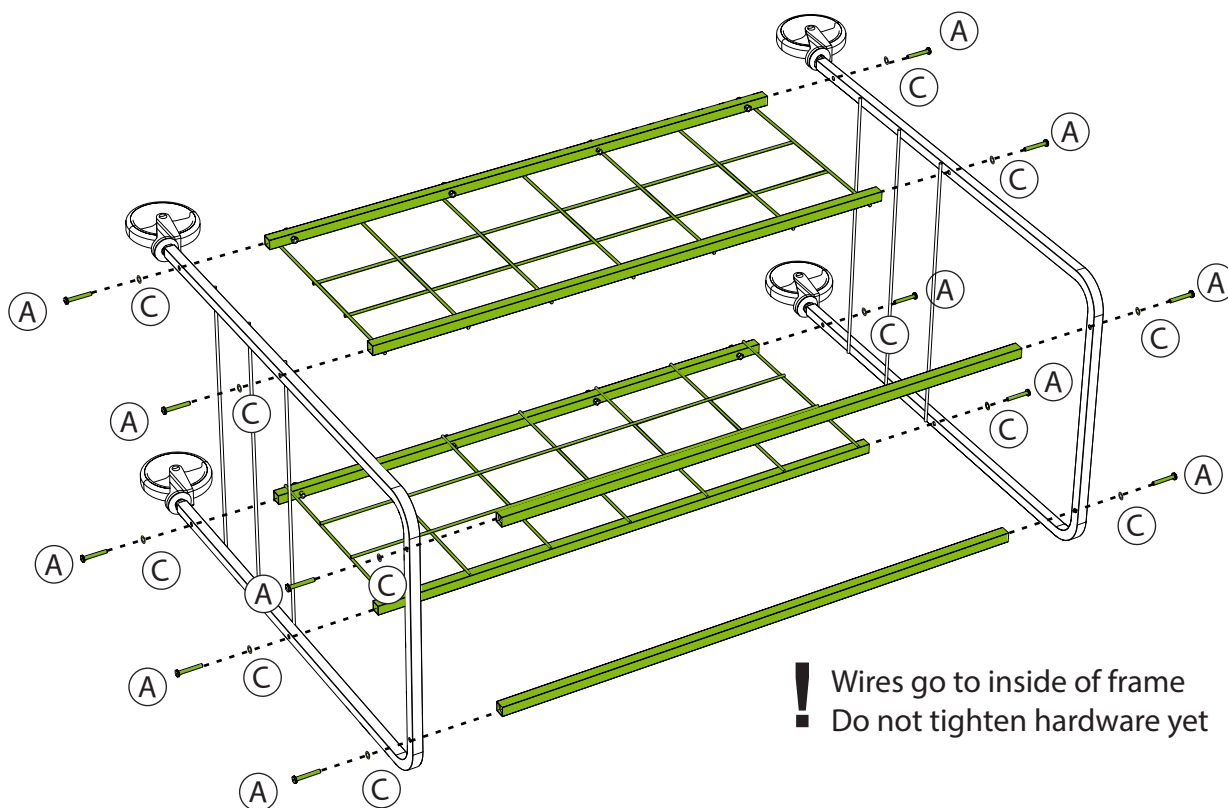

! Wires go to inside of frame
Do not tighten hardware yet

3

Actual Size:

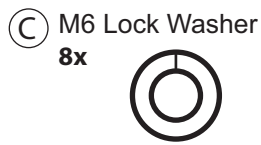
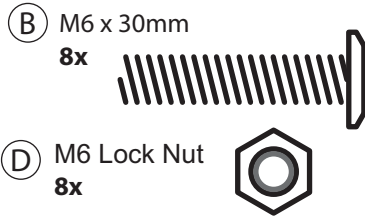

You will need: (Not to Scale)

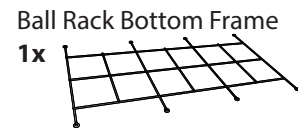

Install Ball Rack Bottom Frame

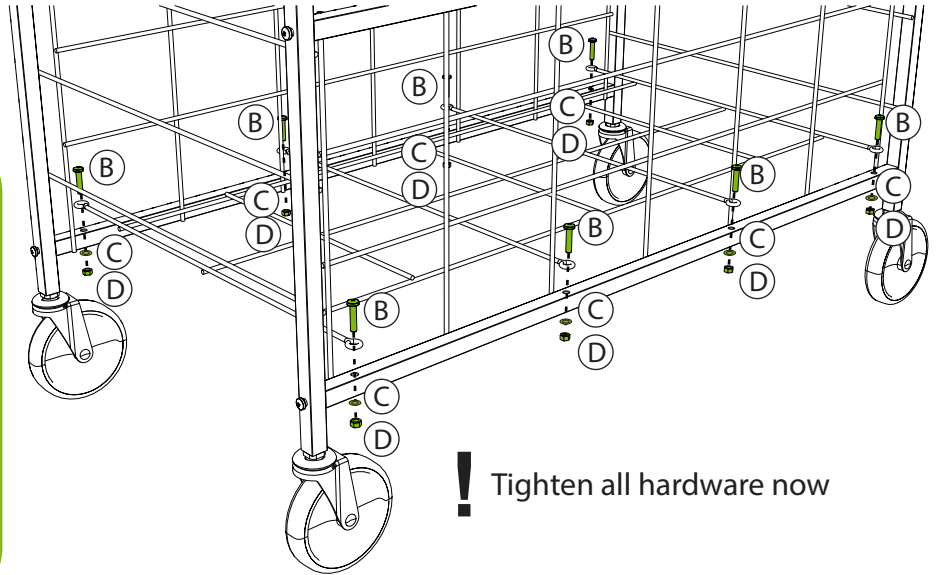
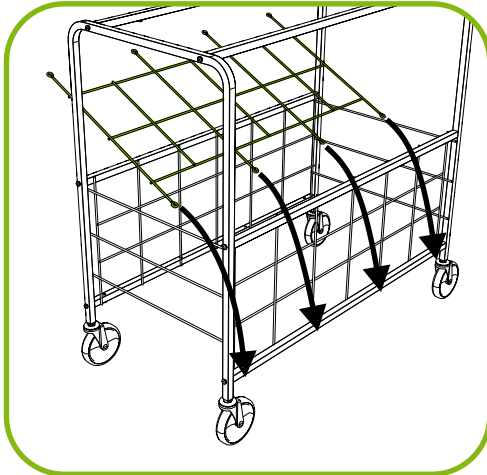

! Tighten all hardware now

4

You will need: (Not to Scale)

Install Handle

Reuse hardware from step 2

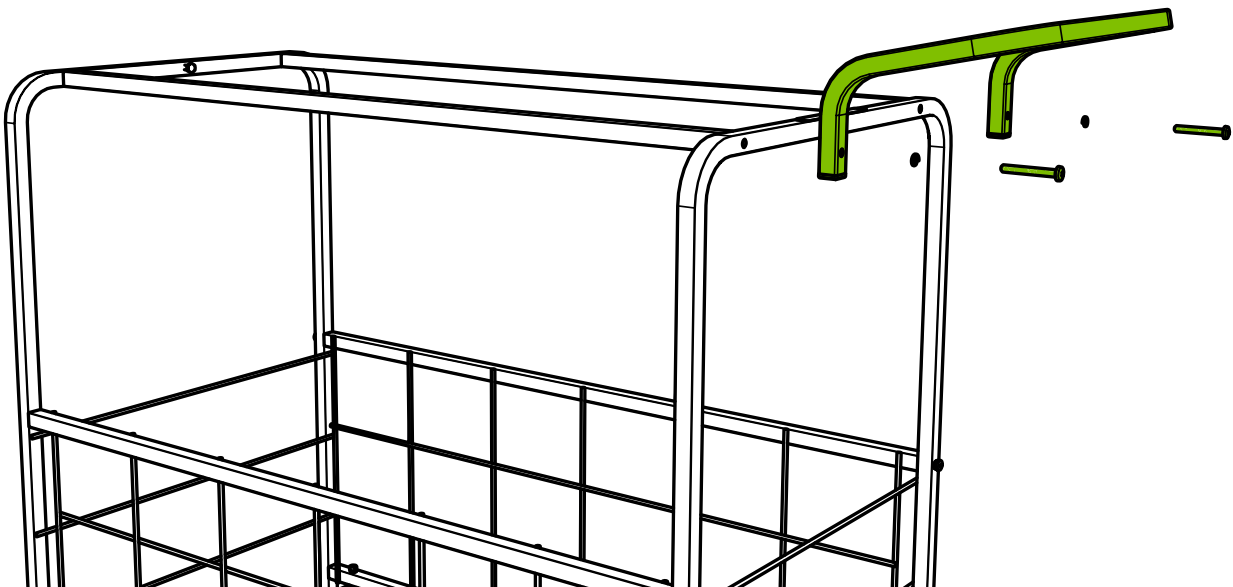

5

Actual Size:

(E) M6 Acorn Nut
4x



(F) M6 Flat Washer
4x



You will need: (Not to Scale)

Lined Magnetic
Dry Erase Board
x1

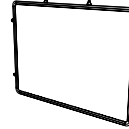

Rack Hook
4x



Wire Rack
2x



Assemble Wire Rack and Install on cart stretchers

1 Assemble wire

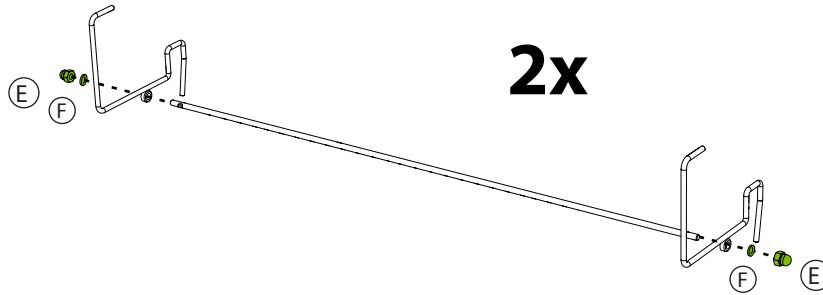

2 Place Wire Rack on stretchers

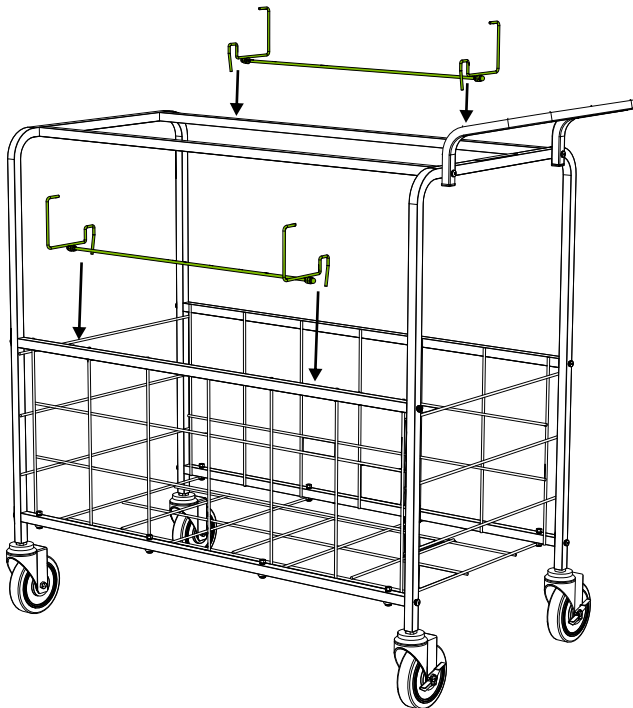

3 Place whiteboard on lower wire hooks



6

Actual Size:

(G) 1x



You will need: (Not to Scale)

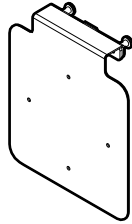

Dispenser Mounting Bracket
1x

Install Hex Screw into Mounting Bracket

Repeat for both Dispenser Mounting Brackets

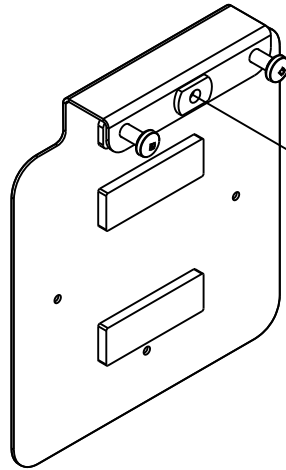

NOTE:
Only install 2 full turns

(G)

7

You will need: (Not to Scale)

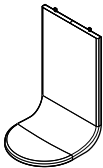

Drip Tray
1x

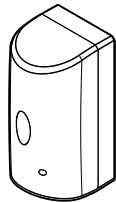

Hand Sanitizer Dispenser
1x

(H) 1x



(L) 1x



(K) 1x



Install Drip Tray onto Dispenser

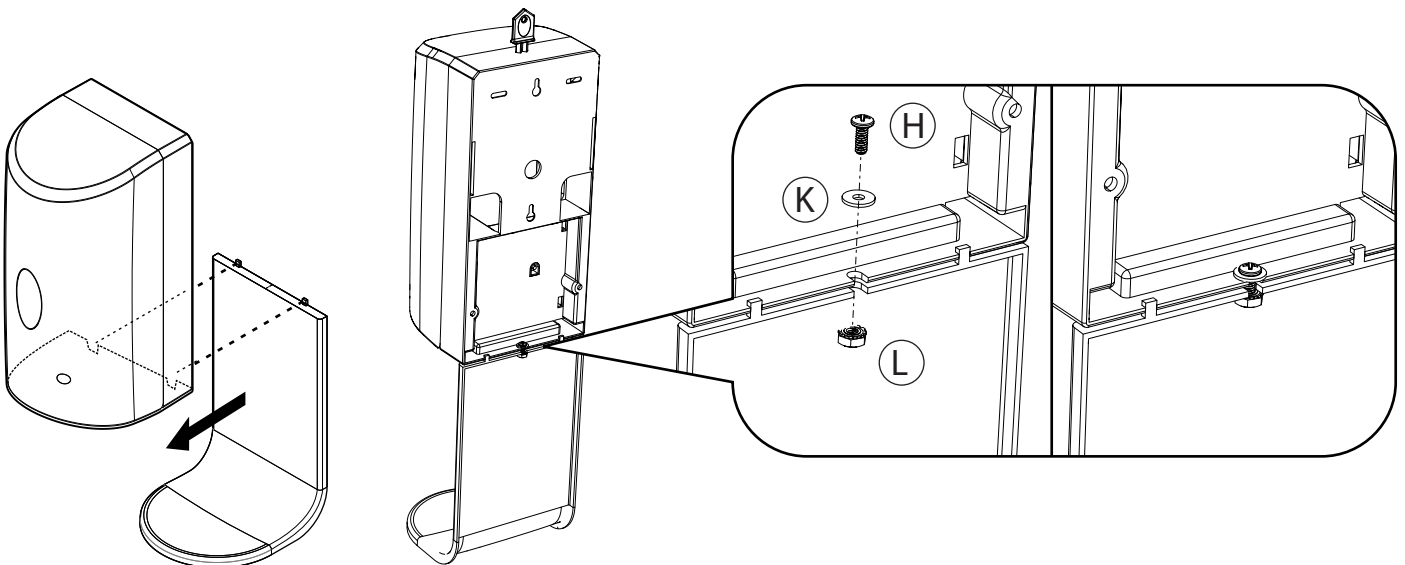

8

Actual Size:

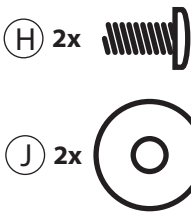

You will need: (Not to Scale)

Dispenser Mounting Bracket
1x

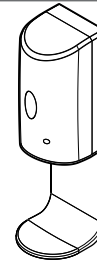
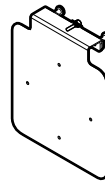

Hand Sanitizer Dispenser and Drip Tray
1x

Install Dispenser onto Mounting Bracket

Select top or side mounting option

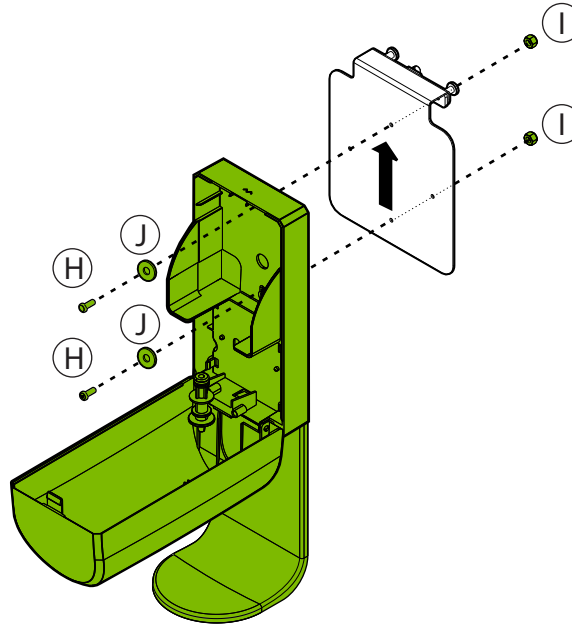

9

You will need: (Not to Scale)

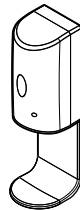

Hand Sanitizer Dispenser and Drip Tray
1x

Install dispenser onto cart

Hook dispenser over end of cart without handle

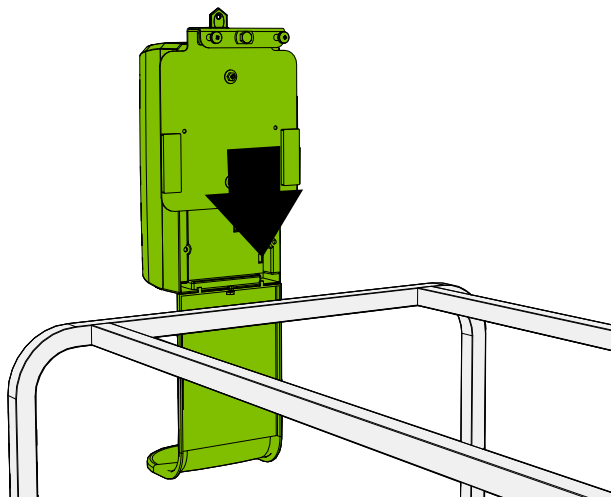

TIGHTEN SCREW WITH WRENCH

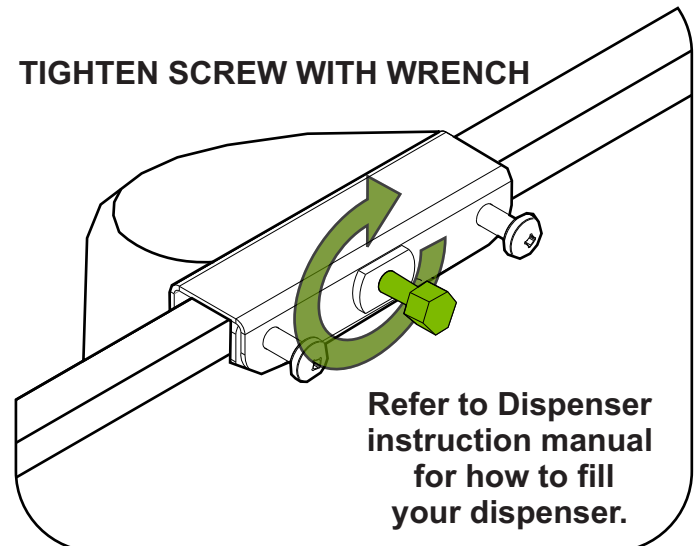

Refer to Dispenser instruction manual for how to fill your dispenser.

Open Tub
3x

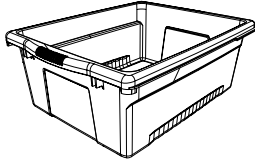

Install Open Tubs into top rack of cart

